



## **Beltown Community Council**

**Angela Brady & Thérèse Casper –  
Office of the Waterfront and Civic Projects  
Bernie Alonzo & Rikerrious Geter – GGN  
February 2023**

# BELL STREET IS ONE OF MANY WATERFRONT SEATTLE PROJECTS





# CONSTRUCTION SCHEDULE

■ Waterfront Seattle 
 ■ Related projects 
 ▤▤▤▤ Concrete strike delays\*

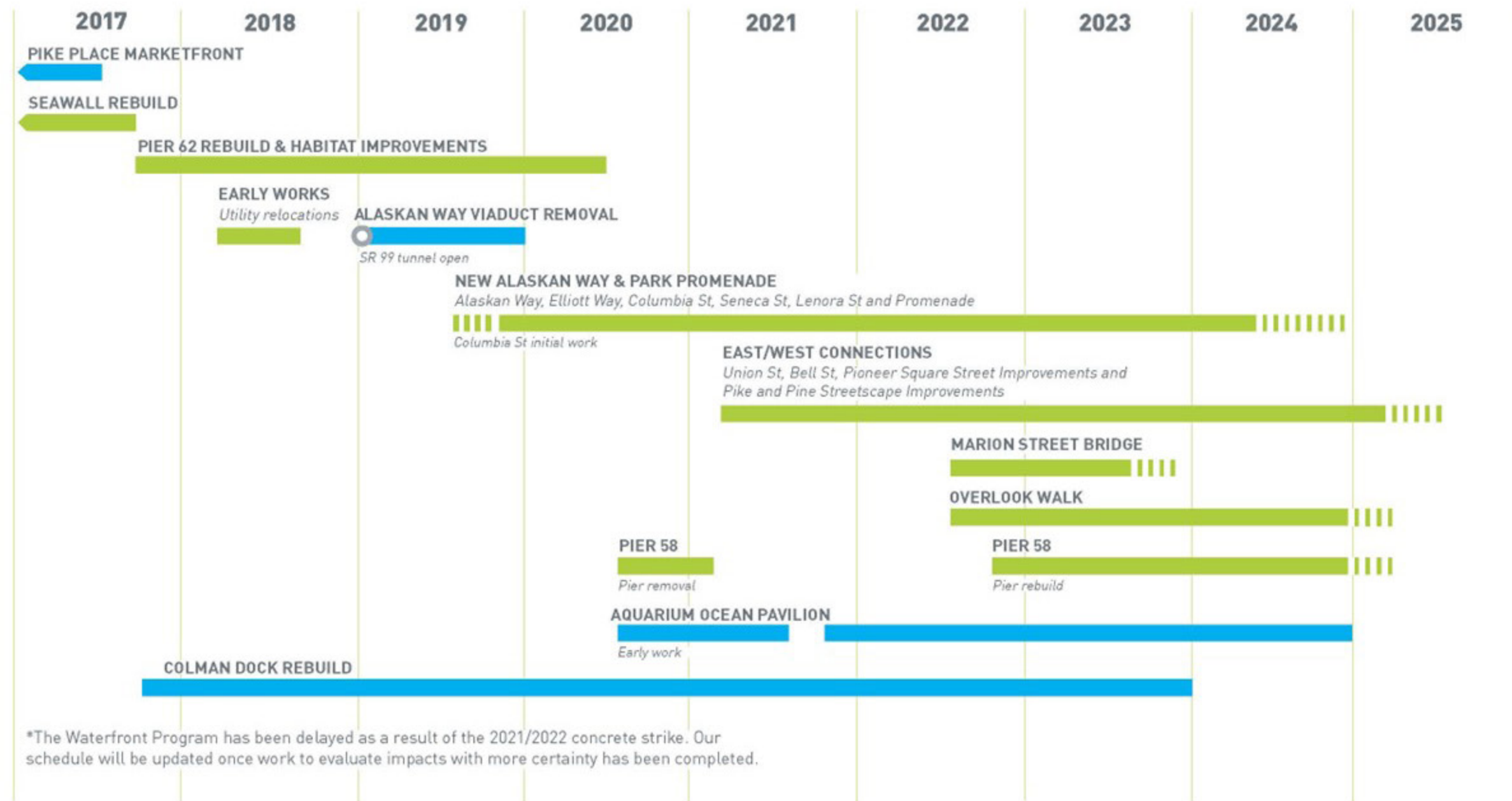

\*The Waterfront Program has been delayed as a result of the 2021/2022 concrete strike. Our schedule will be updated once work to evaluate impacts with more certainty has been completed.

# 2022 WATERFRONT MILESTONES



- June: Marion St Ped Bridge began
- June: Overlook Walk began
- August: Alaskan Way open King to Union & Promenade began
- September: Pier 58 rebuild and Pier 63 removal began
- December: Union St Ped Bridge opened



# ELLIOTT WAY WILL OPEN LATER THIS YEAR



Dec 28 2022 © Tim Rice

# ELLIOTT WAY & LENORA STREET PEDESTRIAN BRIDGE



# ELLIOTT WAY CONNECTION TO BELLTOWN



# BELL STREET PROJECT STARTING THE DESIGN PHASE





# BELL STREET PROJECT OUTREACH



- Notified project neighbors via email, phone calls and door-to-door
- Set out A-frames on Bell St
- Posted an SDOT blog
- Shared on our social channels and via several community newsletters



seattledot @seattledot · Jan 31  
Changes are coming to Bell St & you can help @WaterfrontSEA identify how to best enhance the public space, add new landscaping & amenities, & better connect Belltown to the waterfront!

More info on our blog:



sdotblog.seattle.gov  
Changes are coming to Bell St and Waterfront Seattle wants to hear ...  
Waterfront Seattle is kicking off a design process for the Bell Street project. This blog shares a link to the online open house website.

**We've received over 425 responses to the online open house so far!**



# INTRODUCTION TO GGN





BRINGING THE CUP BACK TO BEANTOWN. PERFECT.

Strega NICO  
In the FAMOUS NORTH END!  
Come dine with us!

DASANI

Caffe Graffiti  
Caffe + Restaurants









## **ROLES AND EXPERIENCE**



BEFORE



AFTER











**EVERY PLACE IS THICK WITH SMALL STORIES**



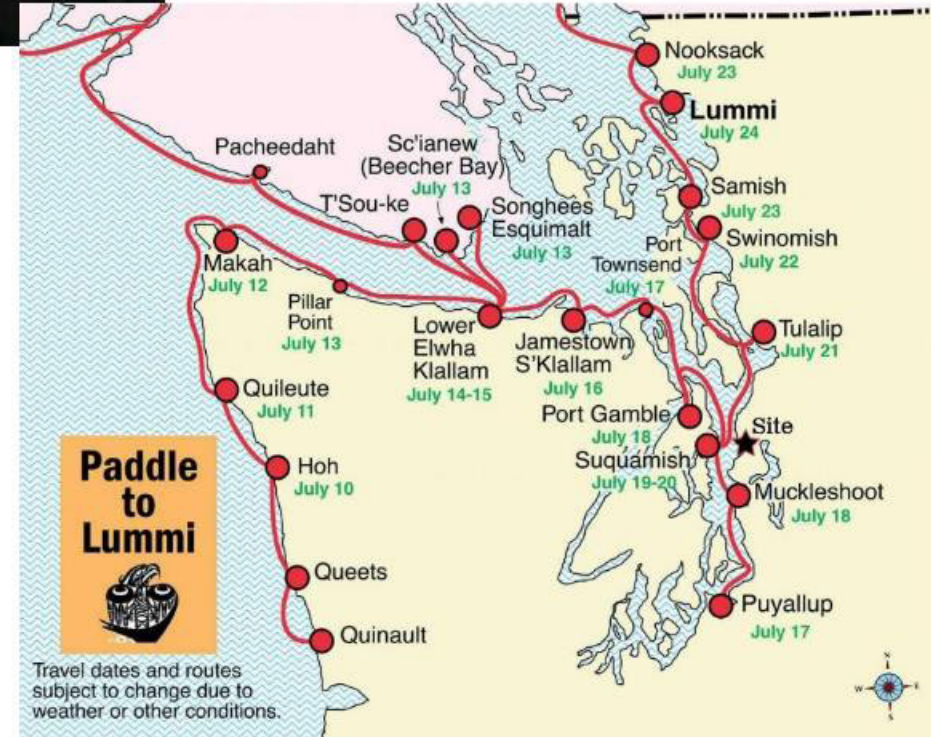



**PRESERVE THE MAMA'S BUILDING &  
HELP SAVE OUR  
BLOCK!**

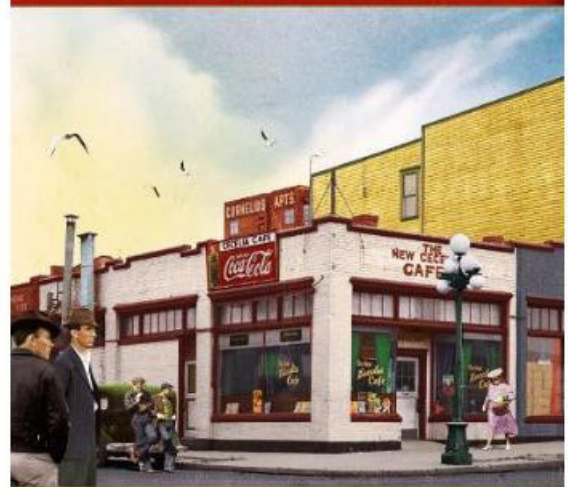

**SHOW YOUR SUPPORT!**  
PLEASE ATTEND THIS LANDMARK MEETING  
WEDNESDAY DECEMBER 7 4:30PM  
**SEATTLE CITY HALL**  
FLOOR L2, ROOM L2-80 BOARDS & COMMISSIONS  
600 4TH AVENUE SEATTLE WA 98104  
BROUGHT TO YOU BY FRIENDS OF HISTORIC BELLTOWN











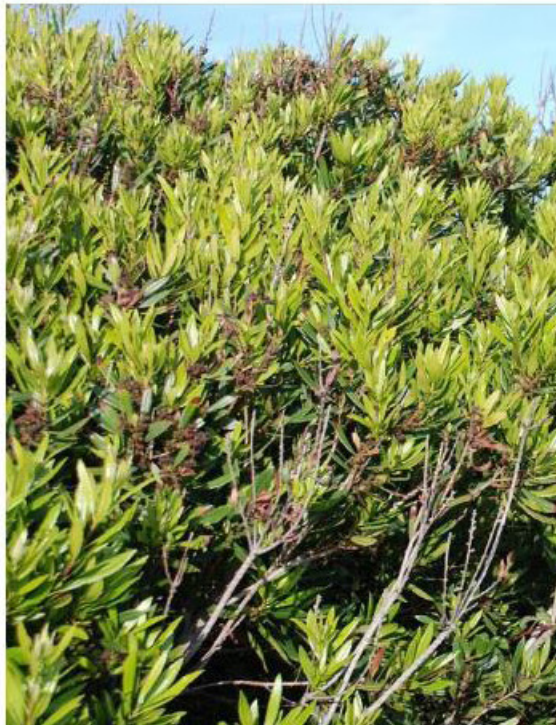



# CONNECTIONS

# LAKE TO BAY AND MARKET TO MOHAI





# SITE ANALYSIS

# BELL ST PRE 2019



ALASKAN WAY

ELLIOTT AVE

WESTERN AVE

1ST AVE

2ND AVE

PED BRIDGE

ALASKAN WAY

BELL ST

BLANCHARD ST





# BELL ST PRE 2019



# BELL ST TODAY



ALASKAN WAY

ELLIOTT AVE

WESTERN AVE

1ST AVE

2ND AVE

PED BRIDGE

BELL ST

NEW ELLIOTT WAY

BLANCHARD ST



# BELL ST TODAY



# BELL ST TODAY





# SITE CIRCULATION

# BELL ST IMPROVEMENTS AREA



ALASKAN WAY

ELLIOTT AVE

WESTERN AVE

1ST AVE

2ND AVE

BATTERY ST

PED BRIDGE

BELL ST

NEW ELLIOTT WAY

BLANCHARD ST



# EXISTING CIRCULATION - VEHICULAR



ALASKAN WAY

BATTERY ST

ELLIOTT AVE

WESTERN AVE

1ST AVE

2ND AVE

PED BRIDGE

BELL ST

NEW ELLIOTT WAY

BLANCHARD ST

- A** Left Turn from Elliott Ave onto Bell St.
- B** Left Turn from Bell St. onto Elliott Ave.
- C** Left Turn from Bell St. onto Western Ave. or continue through to 1st Ave.
- D** Right Turn from Bell St. onto Western Ave. or continue through to Elliott Ave.
- E** Right Turn from 1st Ave to Bell St.
- F** Left Turn from 1st Ave to Bell St.

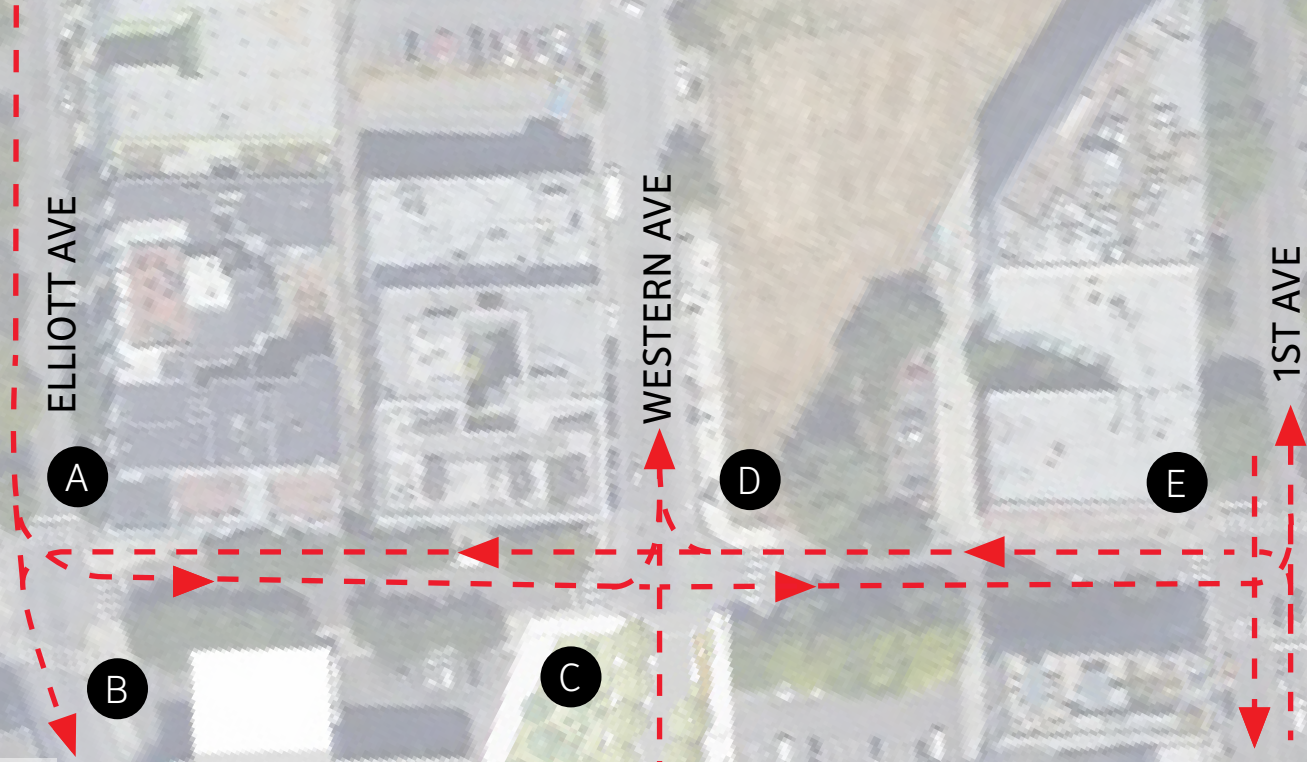

# EXISTING CIRCULATION - PEDESTRIAN





# EXISTING CIRCULATION - BICYCLE

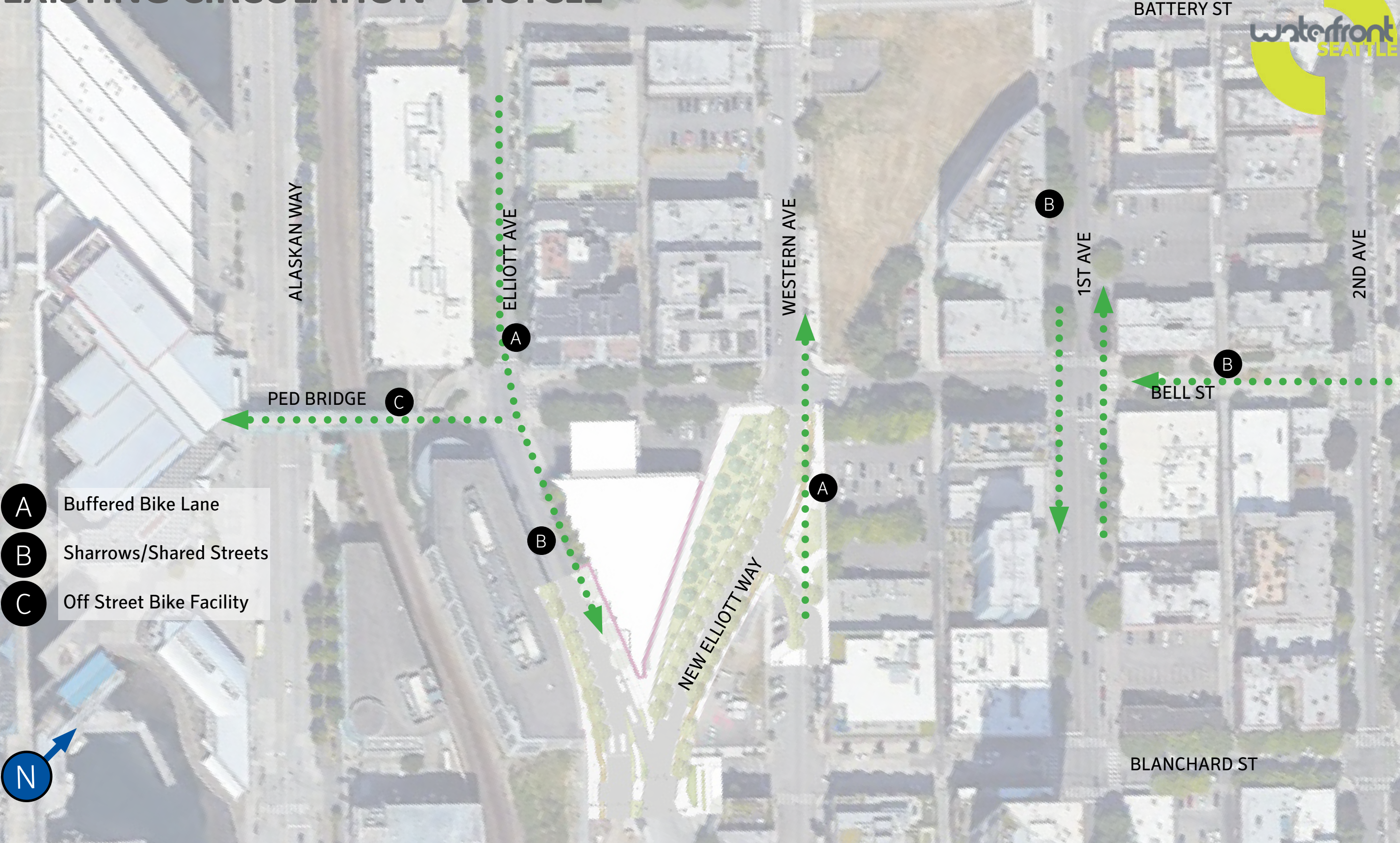

# EXISTING CIRCULATION - COMBINED

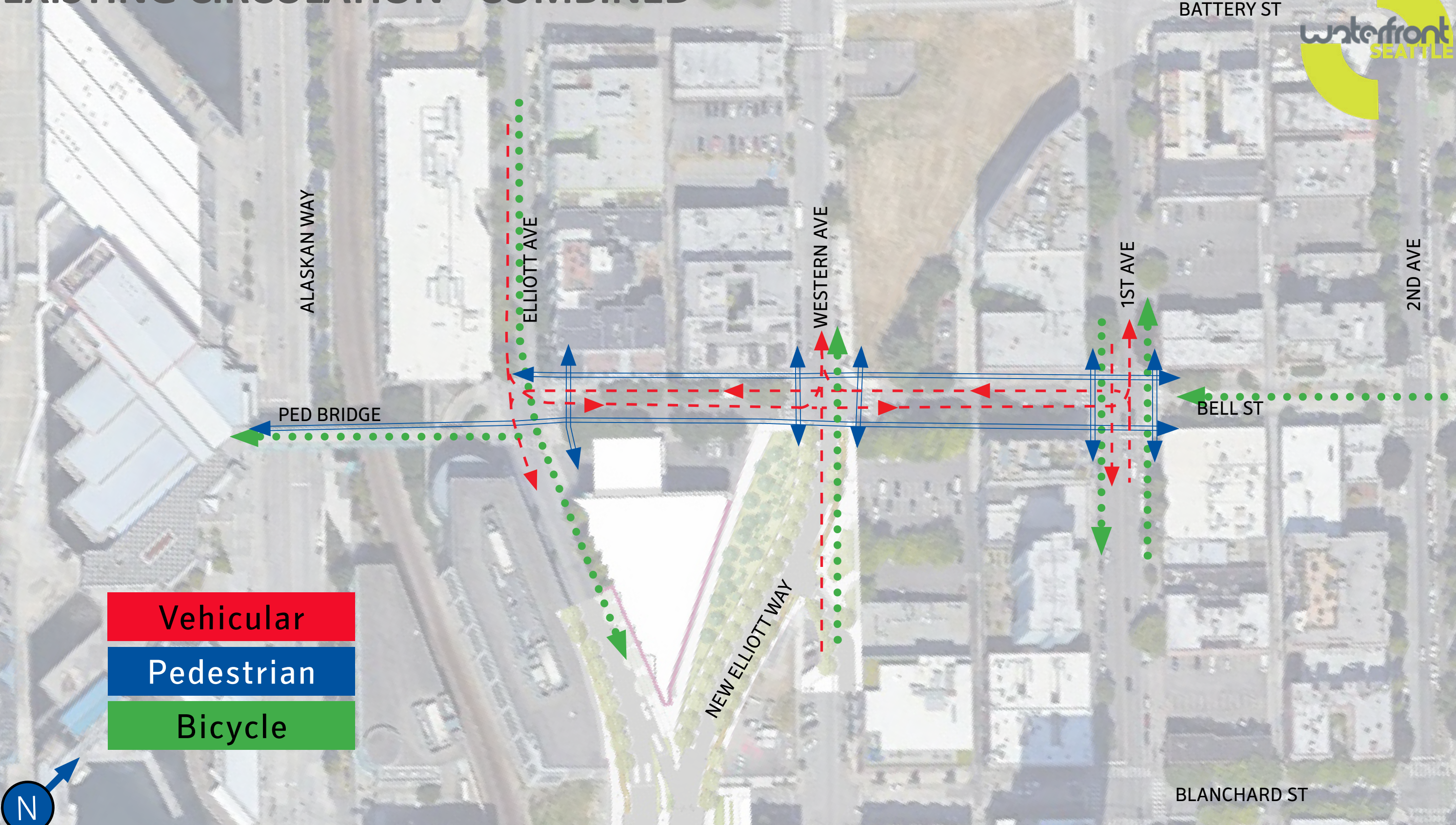

- Vehicular
- Pedestrian
- Bicycle



ALASKAN WAY

ELLIOTT AVE

WESTERN AVE

1ST AVE

2ND AVE

BATTERY ST

PED BRIDGE

BELL ST

NEW ELLIOTT WAY

BLANCHARD ST

# PLANNED CIRCULATION - VEHICULAR

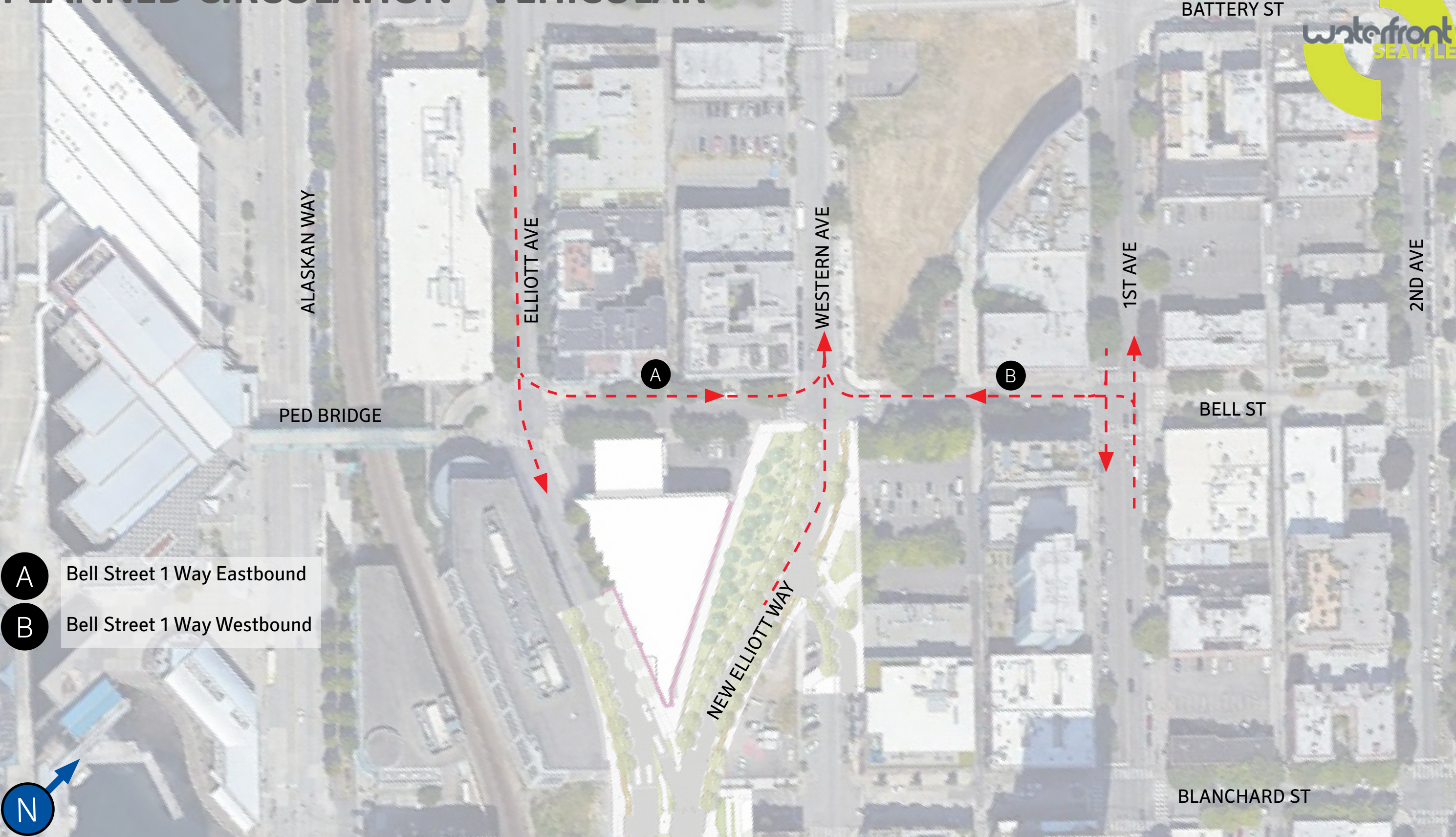

- A Bell Street 1 Way Eastbound
- B Bell Street 1 Way Westbound



# EXISTING CIRCULATION - PEDESTRIAN



ALASKAN WAY

ELLIOTT AVE

WESTERN AVE

1ST AVE

2ND AVE

PED BRIDGE

BELL ST

NEW ELLIOTT WAY

BLANCHARD ST



# PLANNED CIRCULATION - BICYCLE



A B TBD Bicycle

C Western Ave Bike Facility Improvements



# PLANNED CIRCULATION - COMBINED



ALASKAN WAY

ELLIOTT AVE

WESTERN AVE

1ST AVE

2ND AVE

PED BRIDGE

BELL ST

NEW ELLIOTT WAY

BLANCHARD ST

- Vehicular
- Pedestrian
- Bicycle
- TBD Bicycle

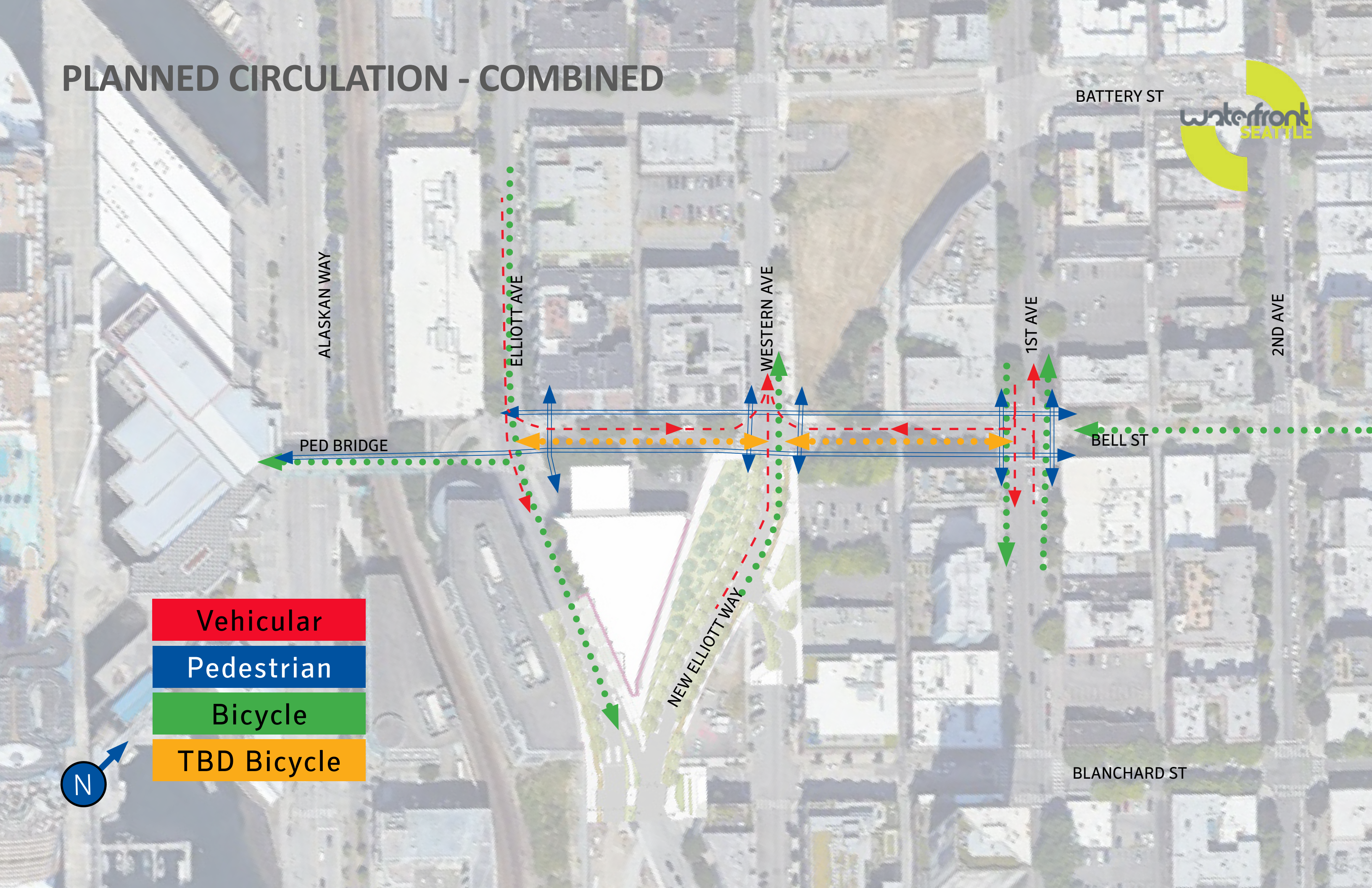



## **SITE CONSIDERATIONS**

# ZONING DESIGNATION

Downtown Mixed Residential/Commercial 95/75 (DMR/C 95/75)

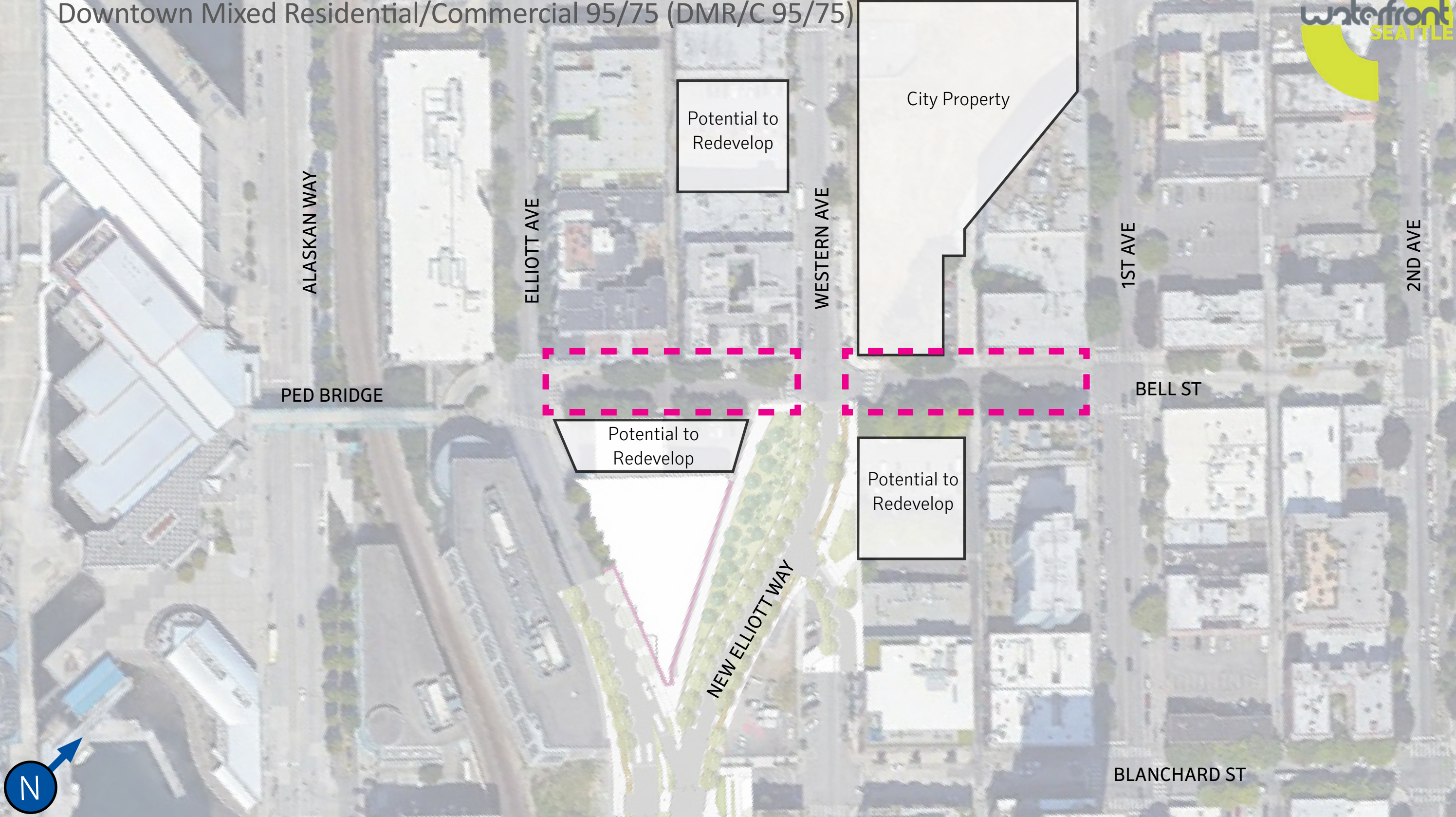



# BELL ST - EXISTING LIGHTING AND TREES



View West from 1st and Bell St.



View East from Western Ave and Bell St.



View East from Elliott Ave and Bell St.



View East from Western Ave and Bell St.

# REPURPOSING HISTORIC SIGN BRIDGE STRUCTURE



# SUN STUDY - SPRING/FALL EQUINOX

Hours of Sunlight



ALASKAN WAY

ELLIOTT AVE

WESTERN AVE

BATTERY ST

1ST AVE

2ND AVE

PED BRIDGE

BELL ST

NEW ELLIOTT WAY

BLANCHARD ST



# SUN STUDY - SUMMER SOLSTICE

Hours of Sunlight

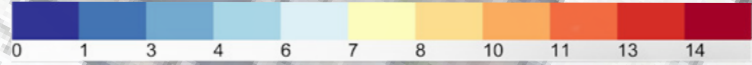

ALASKAN WAY

ELLIOTT AVE

WESTERN AVE

BATTERY ST

1ST AVE

2ND AVE

PED BRIDGE

BELL ST

NEW ELLIOTT WAY

BLANCHARD ST



# SUN STUDY - WINTER SOLSTICE

Hours of Sunlight



ALASKAN WAY

ELLIOTT AVE

WESTERN AVE

BATTERY ST

1ST AVE

2ND AVE

PED BRIDGE

BELL ST

NEW ELLIOTT WAY

BLANCHARD ST



# EXISTING SECTIONS

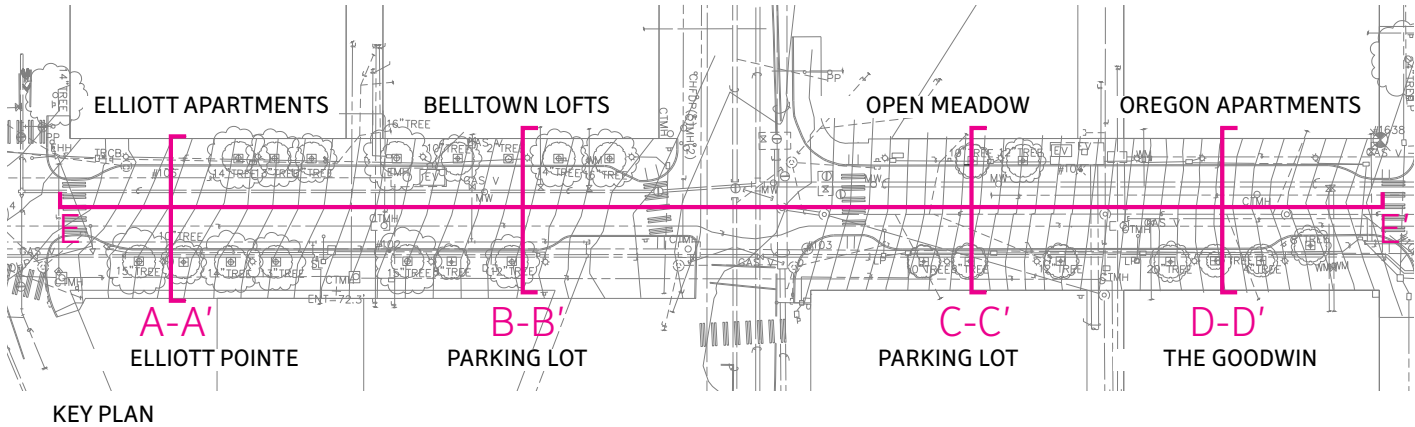
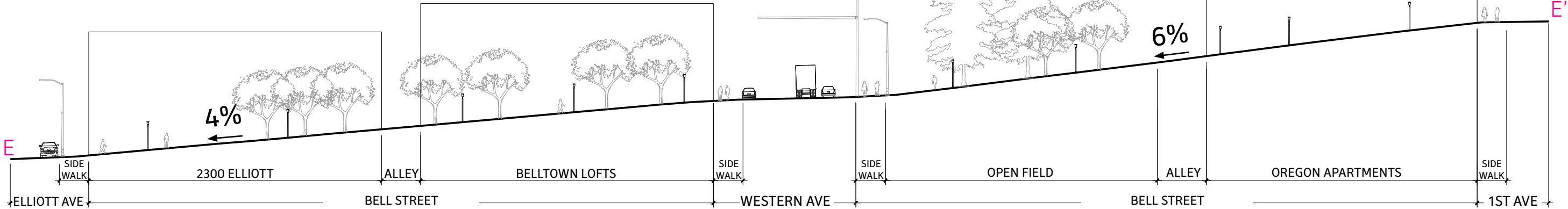
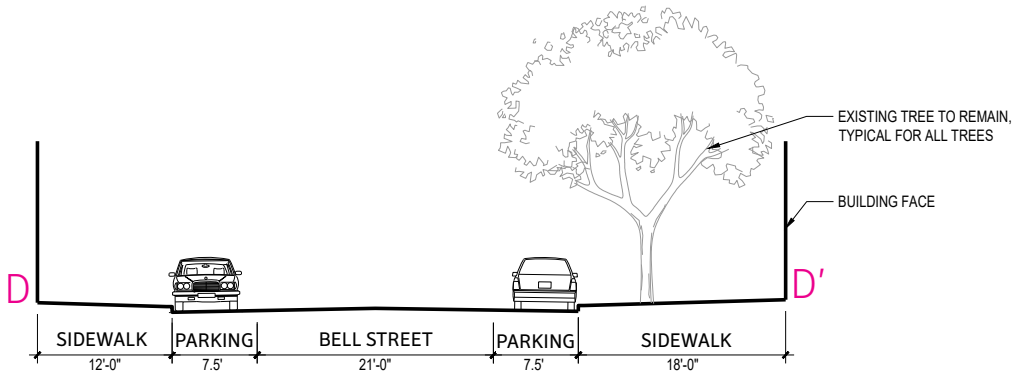
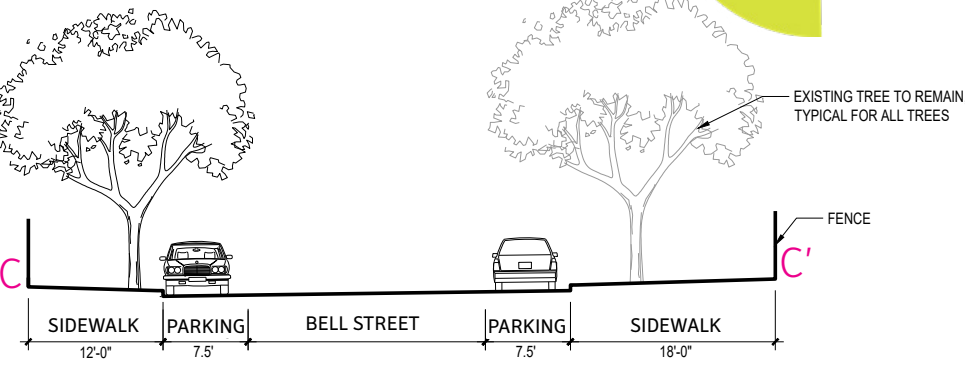
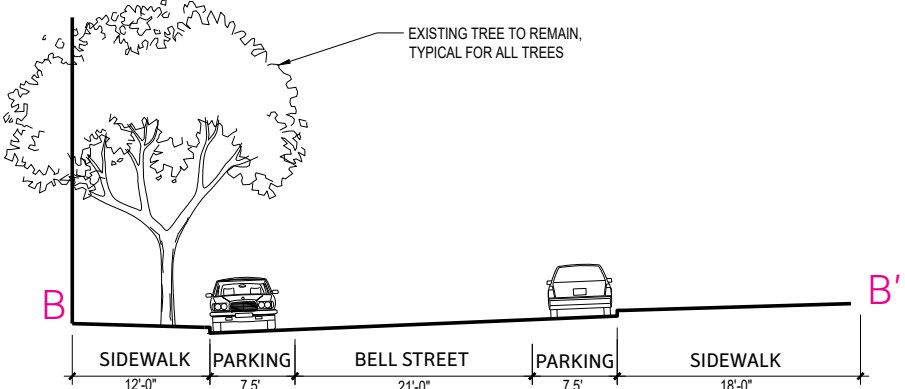
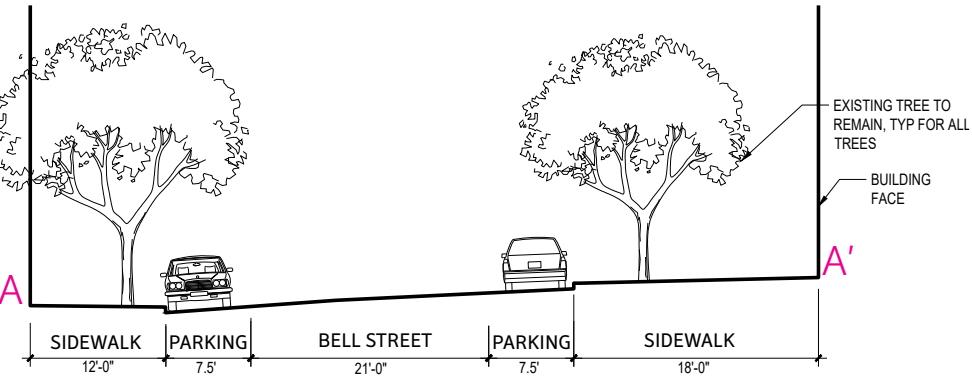

KEY PLAN

# STREET DESIGNATION

## Downtown Neighborhood Access - Non Arterial

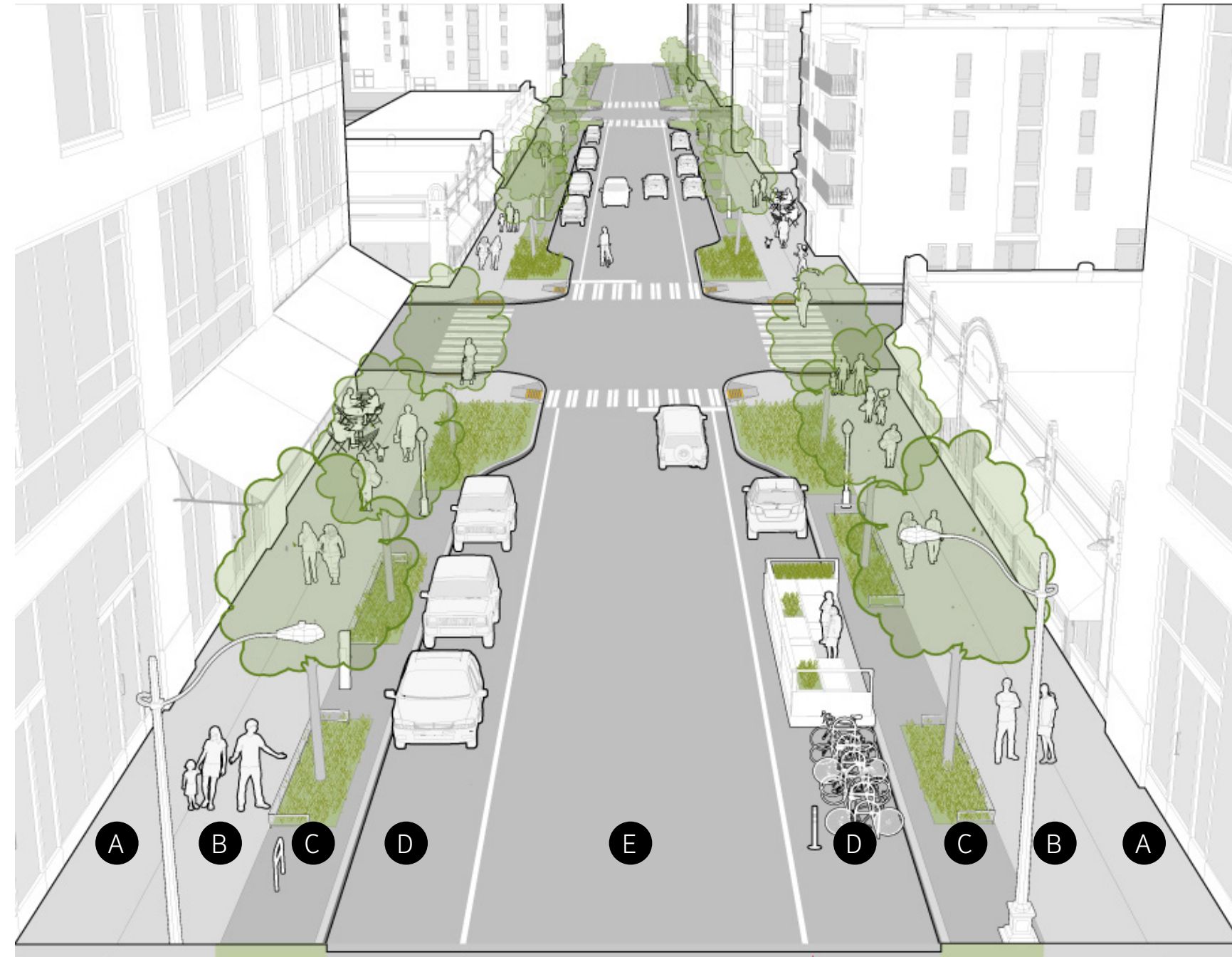

- A** 0-6' Frontage Zone
- B** 6' Pedestrian Clear Zone
- C** 6' Landscape Furnishing Zone
- D** 8' Flex Zone
- E** 20' Travel Lane (2 way)

# BELL ST

Today

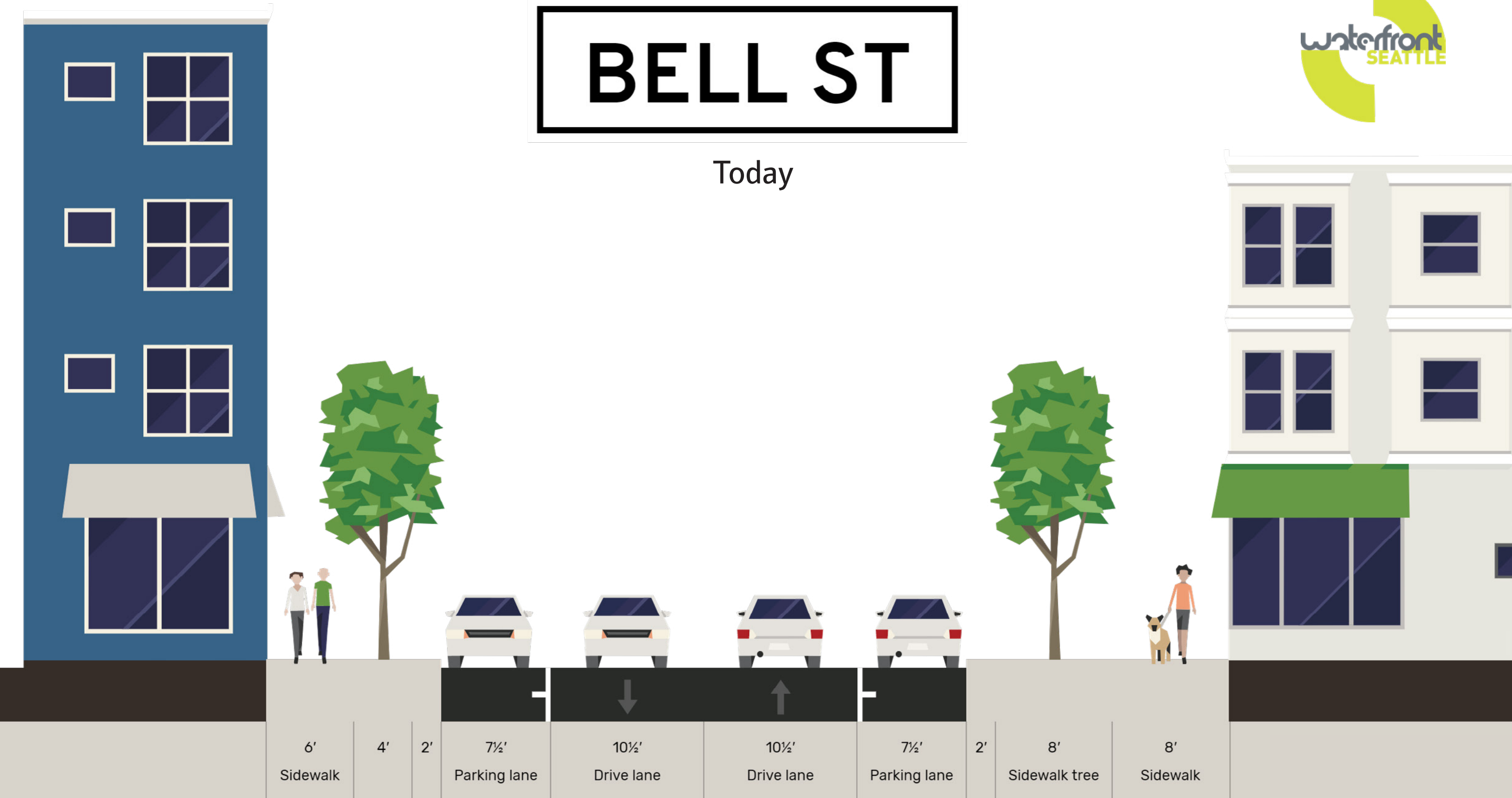



# BELL ST

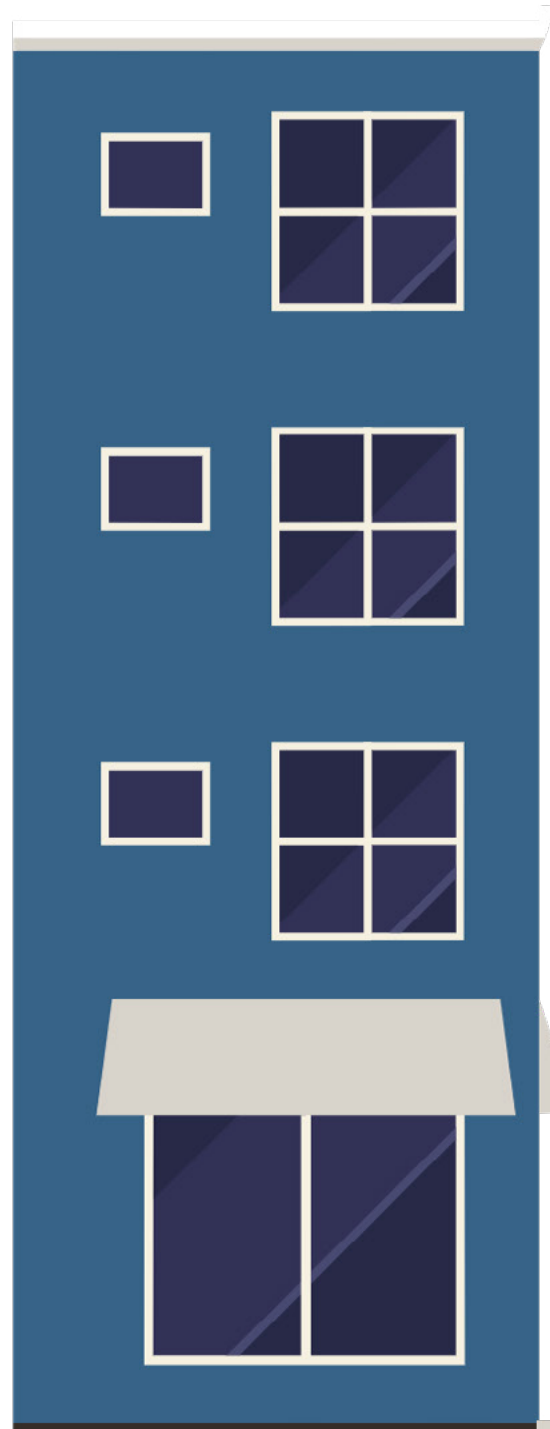

Optional parking lane removal



Travel Lane to be removed



Optional parking lane removal



6'	4'	2'	7½'	10½'	10½'	7½'	2'	8'	8'
Sidewalk			Parking lane	Drive lane	Drive lane	Parking lane	Sidewalk tree	Sidewalk	

# BELL ST

Planned Circulation with a travel lane removal yields approx 10.5' for improvements

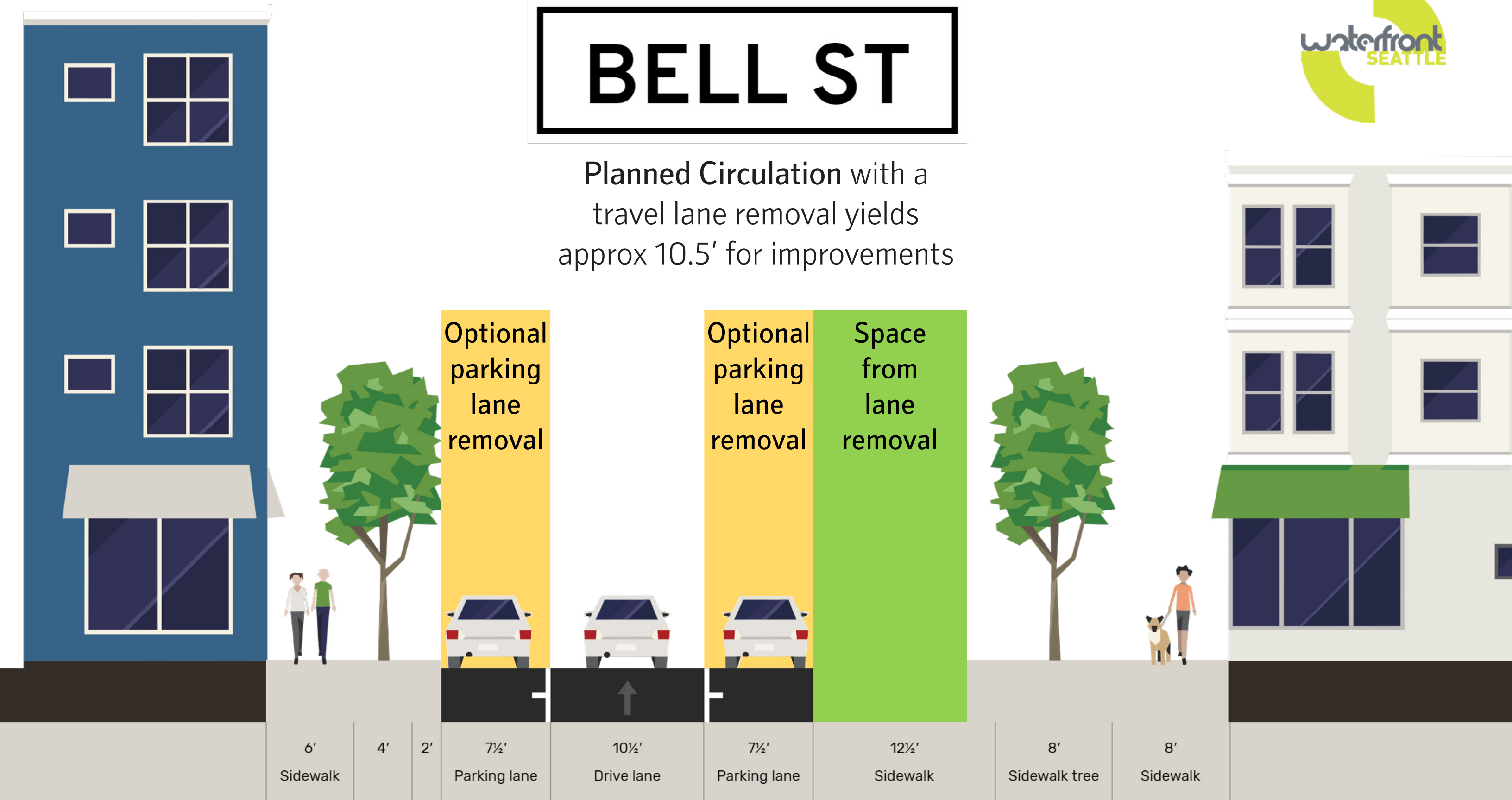

# BELL ST

Planned Circulation with a travel lane removal and 1 lane of parking yields approx. 20' for improvements

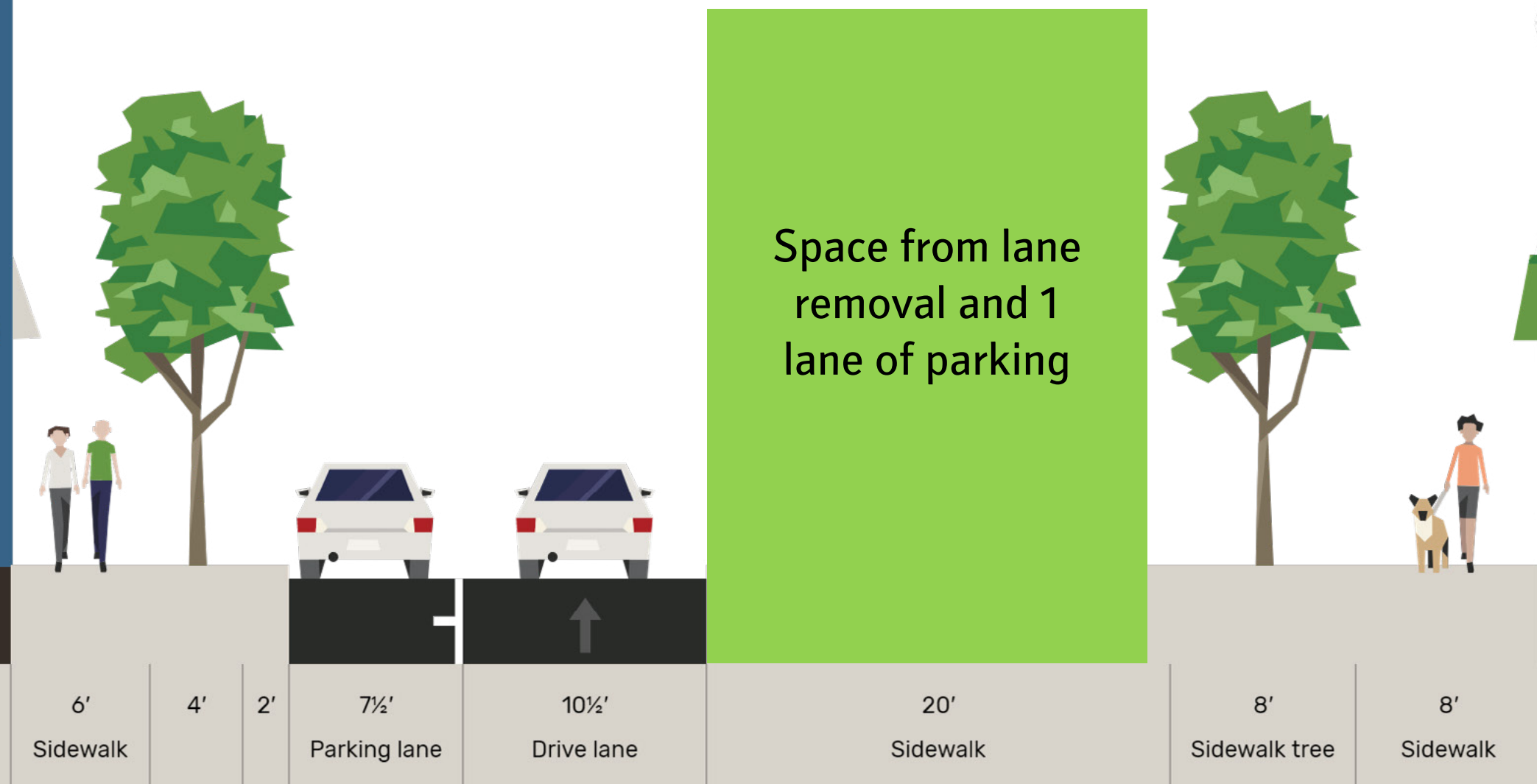

# BELL ST

Planned Circulation with a travel lane removal and all parking yields approx. 26' for improvements





Total Project Budget is **\$3.3 Million**

- This number includes design, permitting, and construction fees.



# BELL STREET PROJECT SURVEY QUESTIONS

# BELL STREET PROJECT SURVEY QUESTIONS



**What are your current impressions of Bell St, between First Ave and Elliott Ave?**



# BELL STREET PROJECT SURVEY QUESTIONS



**Are there any specific improvements that you would like us to consider?**

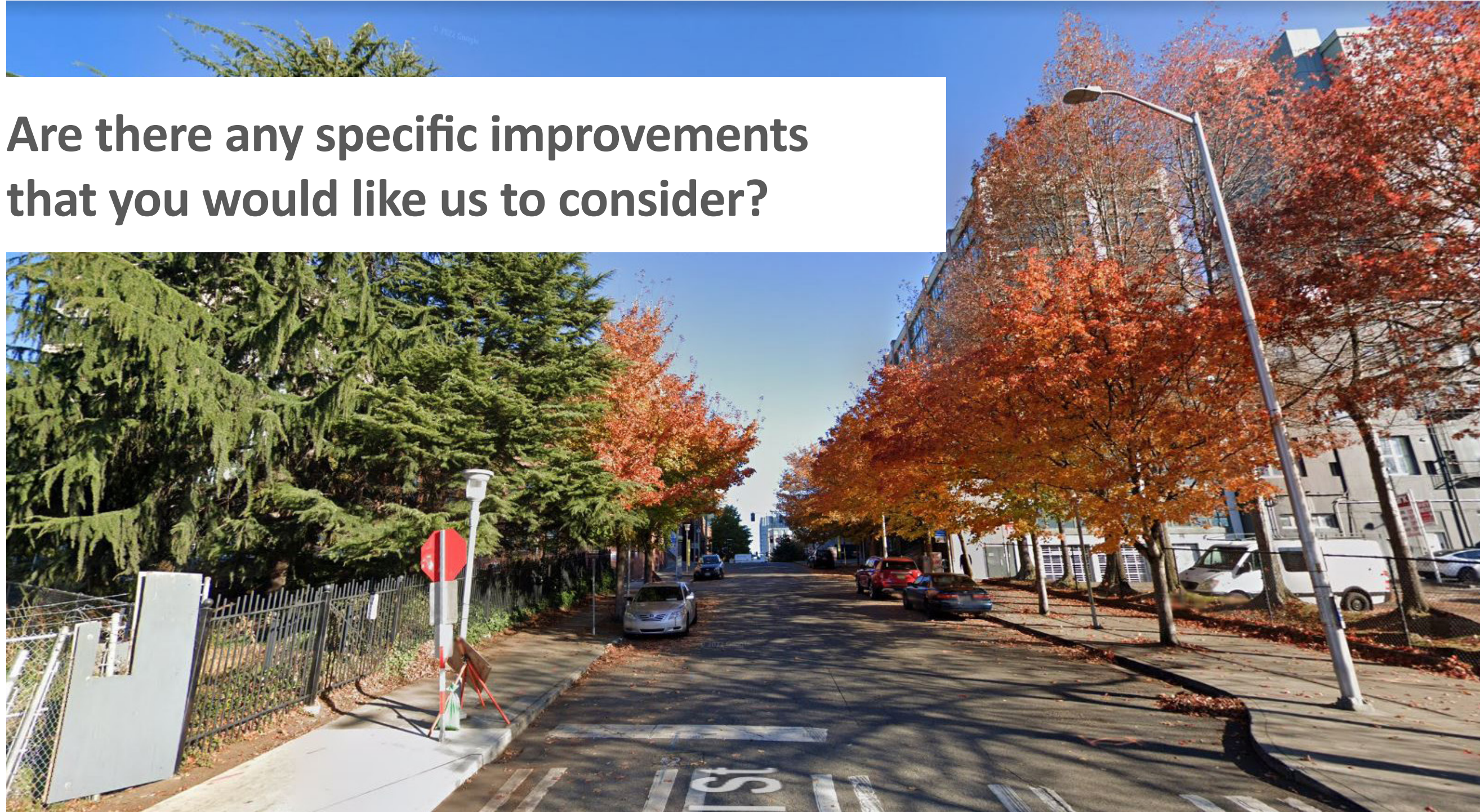



# BELL STREET PROJECT SURVEY QUESTIONS



**Are there any specific improvements that you would like us NOT to consider?**



# BELL STREET PROJECT NEXT STEPS



- **Develop design concept alternatives based on feedback received**
  - Please fill out online survey by February 12!
- **Provide update at next Belletown Community Council briefing, March 8**
- **Share concept alternatives in second online open house**
- **Reach final design in late 2023**



## QUESTIONS?

**Contact us at:**

info@waterfrontseattle.org

206.499.8040

[waterfrontseattle.org](http://waterfrontseattle.org)