

PIKE PINE RENAISSANCE: ACT ONE

CENTRAL SEATTLE GREENWAYS
30% DESIGN REVIEW

June 8, 2020

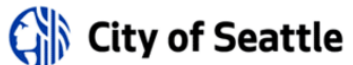

PROJECT LIMITS

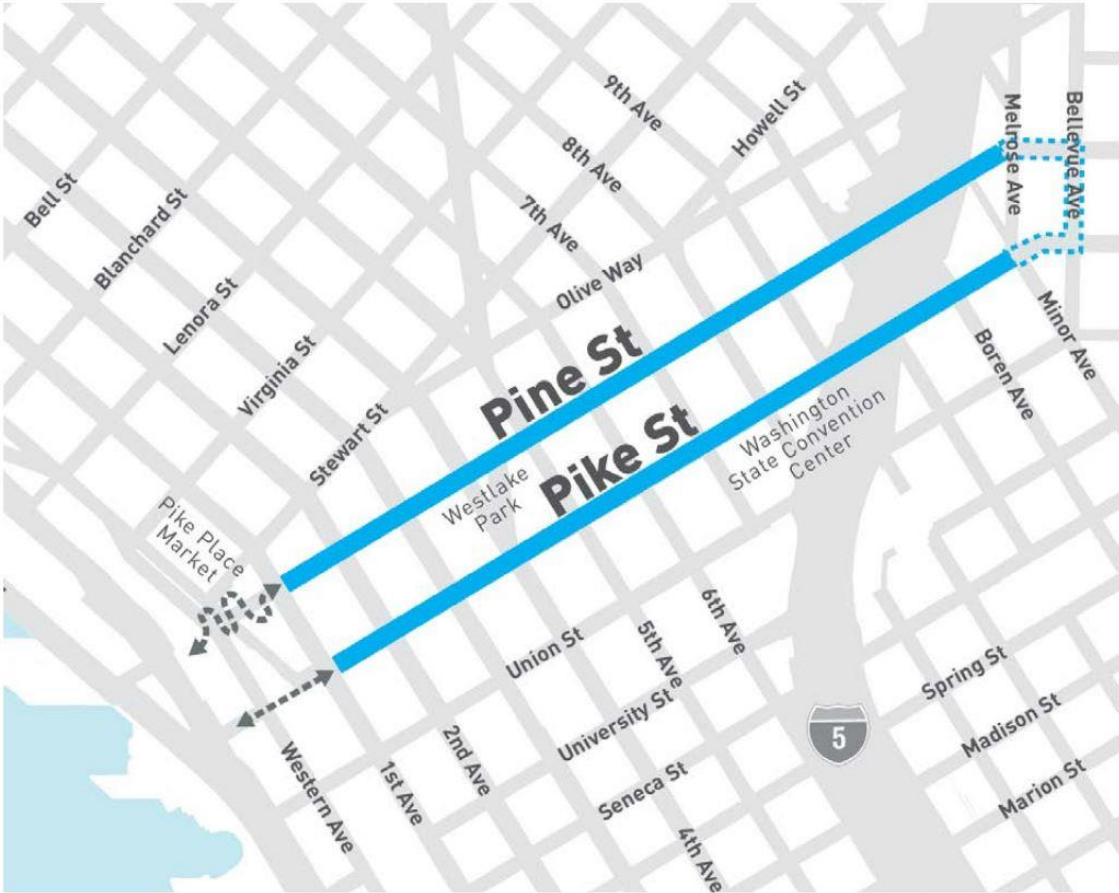

IMPLEMENT PROTECTED BIKE LANES

- Provide safe and attractive protected bike lanes on Pike and Pine, serving a wide range of users and making key connections in the City's bike network

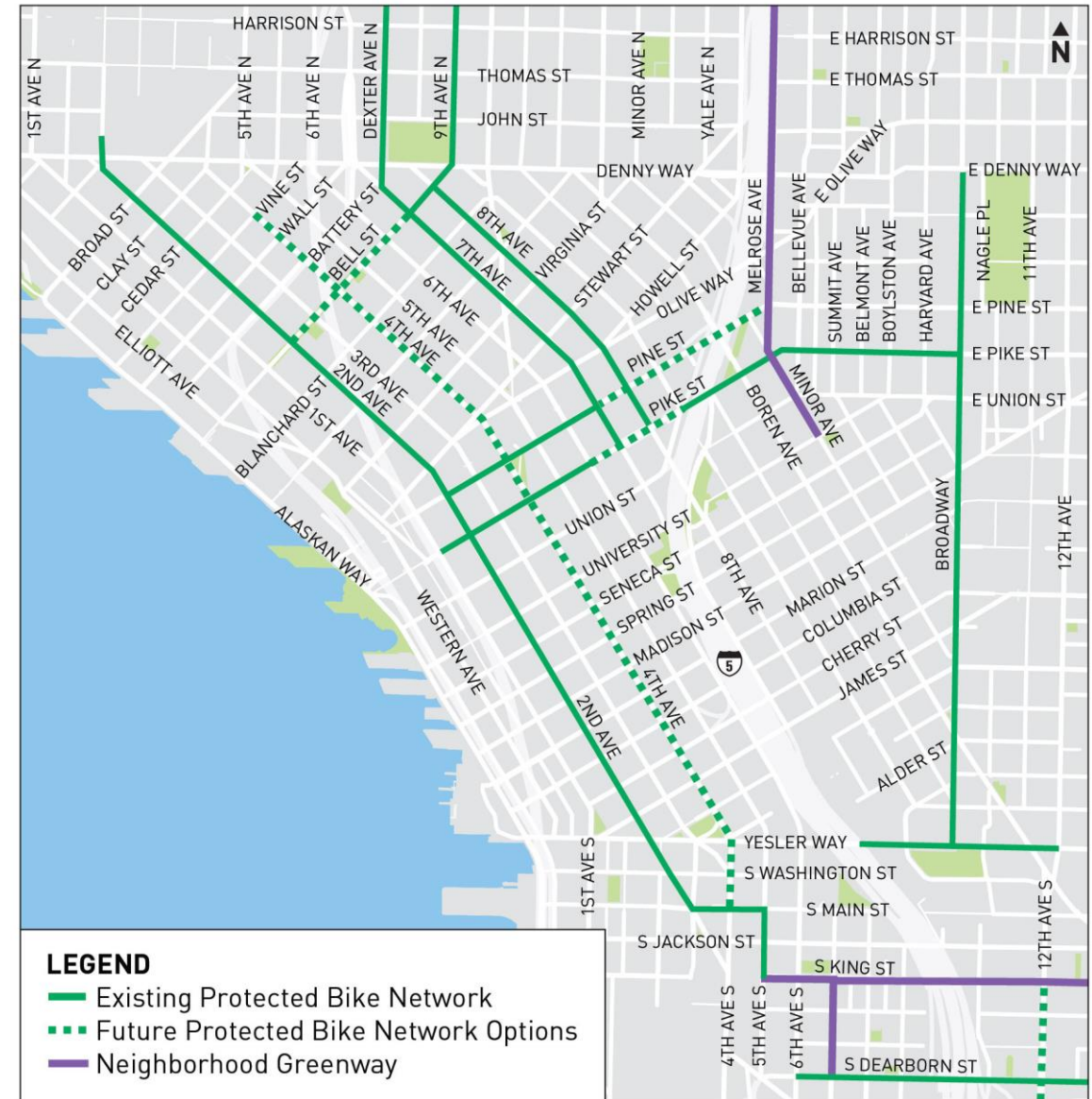

BUDGET SOURCES

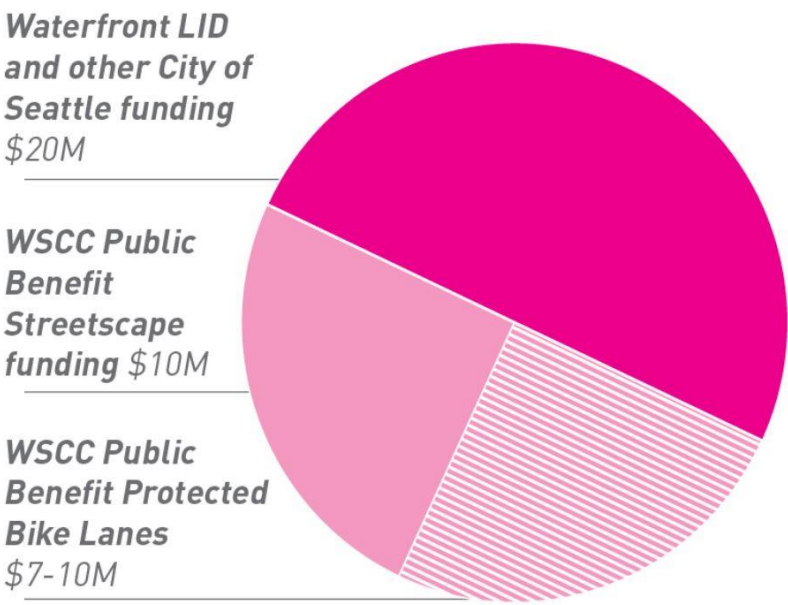

TOTAL = \$37 - 40M*

**Range in values is dependent on how much of WSCC public benefits funding for bicycle improvements are allocated to permanent improvements within the project area*

FUNDING

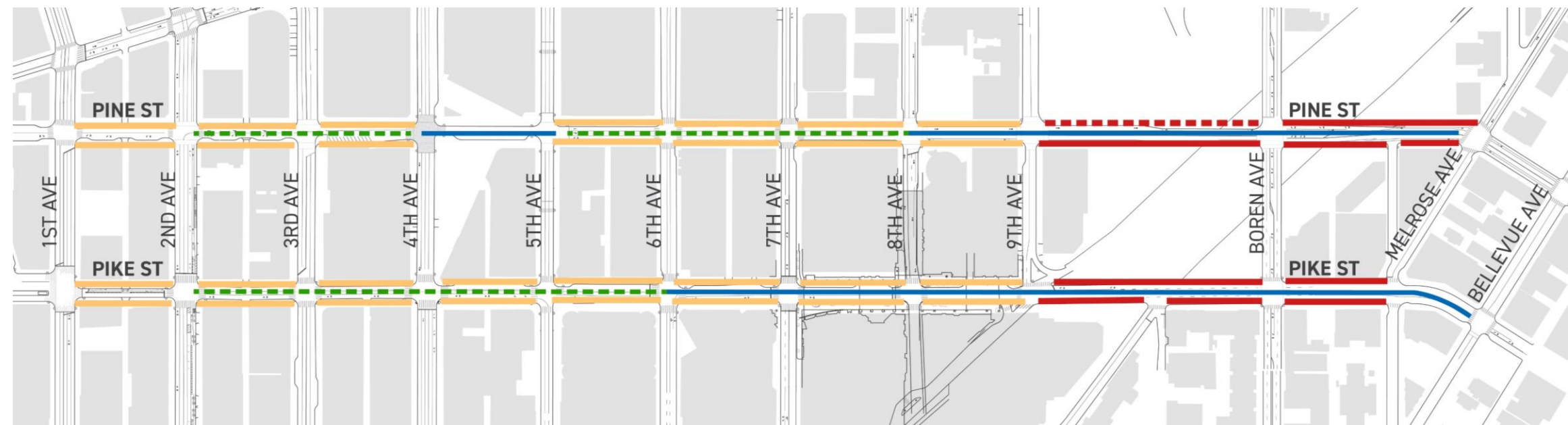

- STREETSCAPE: WEST FOCUS AREA AND CENTRAL FOCUS AREA (FUNDING FROM WATERFRONT LID)
- STREETSCAPE: EAST FOCUS AREA (FUNDING FROM WSCC STREET VACATION PUBLIC BENEFIT PACKAGE)
- STREETSCAPE: WSCC ON-SITE IMPROVEMENTS

- ADD PROTECTED BIKE LANES (FUNDING FROM WSCC STREET VACATION PUBLIC BENEFIT PACKAGE)
- ENHANCE PROTECTED BIKE LANES (SHARED FUNDING)

ELEMENTS OF CONTINUITY

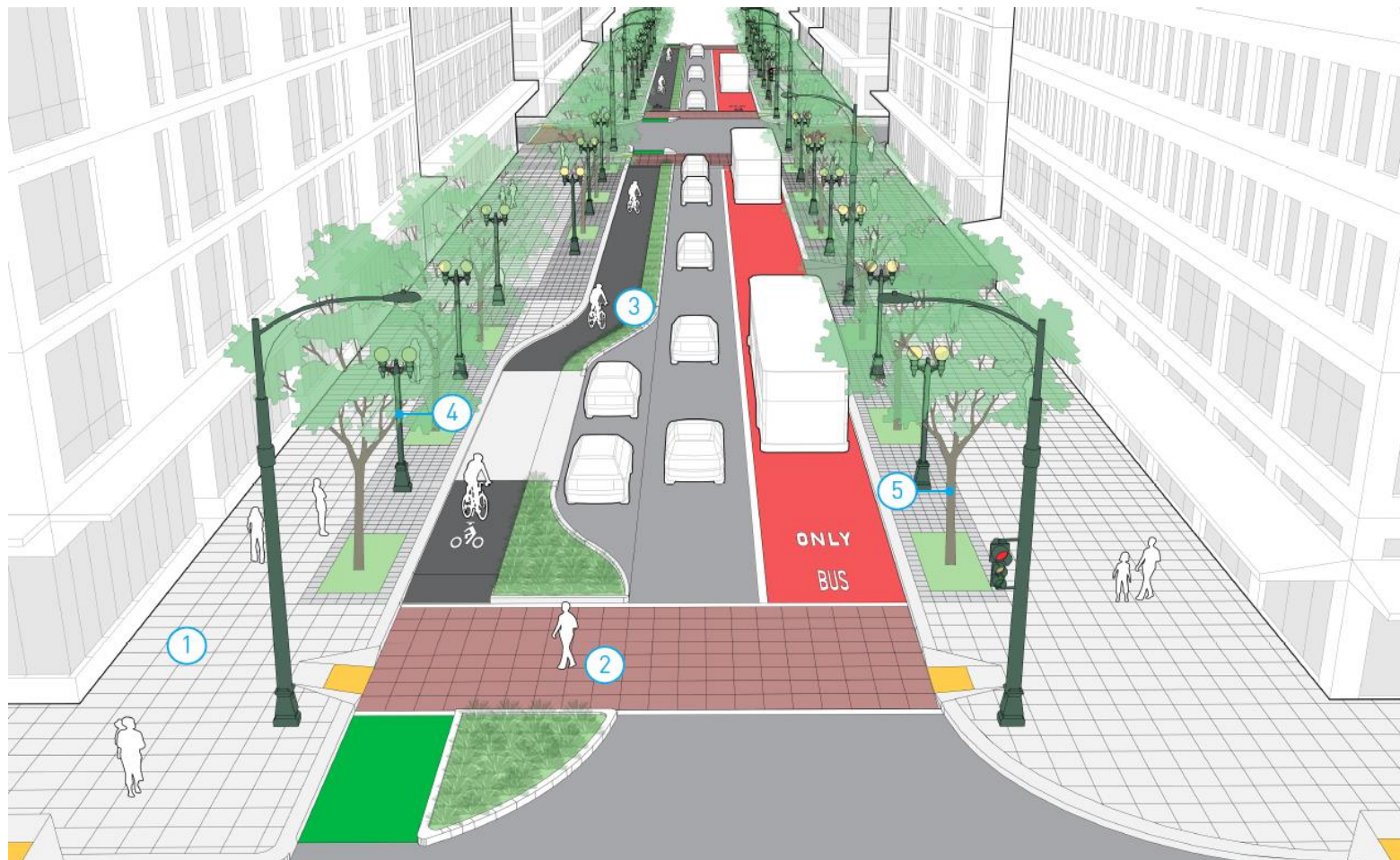

PROPOSED STANDARD BLOCK

- ① Consistent quality of sidewalk paving
- ② Signature crosswalk design
- ③ Protected bike lane and vegetated buffer
- ④ Two-globe pedestrian lighting
- ⑤ Enhanced tree canopy

BIKE LANE BUFFER



BIKE LANE BUFFER PLANTERS



100 PIKE EXISTING



100 PIKE PROPOSED



100 PIKE PROPOSED

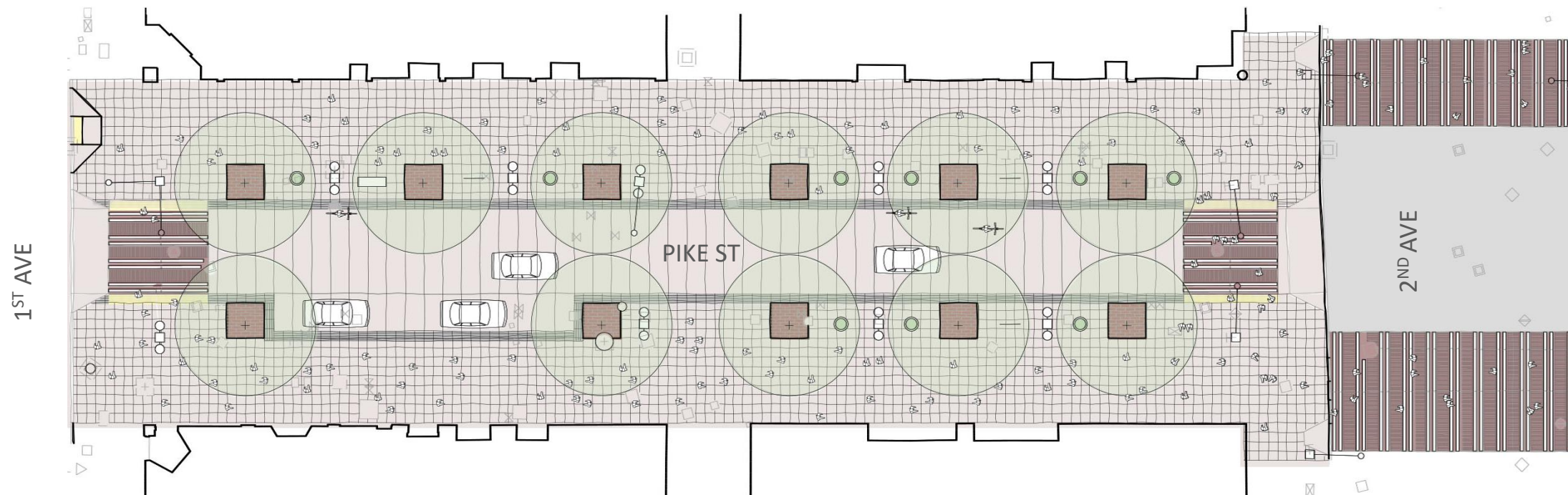

100 PINE EXISTING



100 PINE PROPOSED



100 PINE PROPOSED

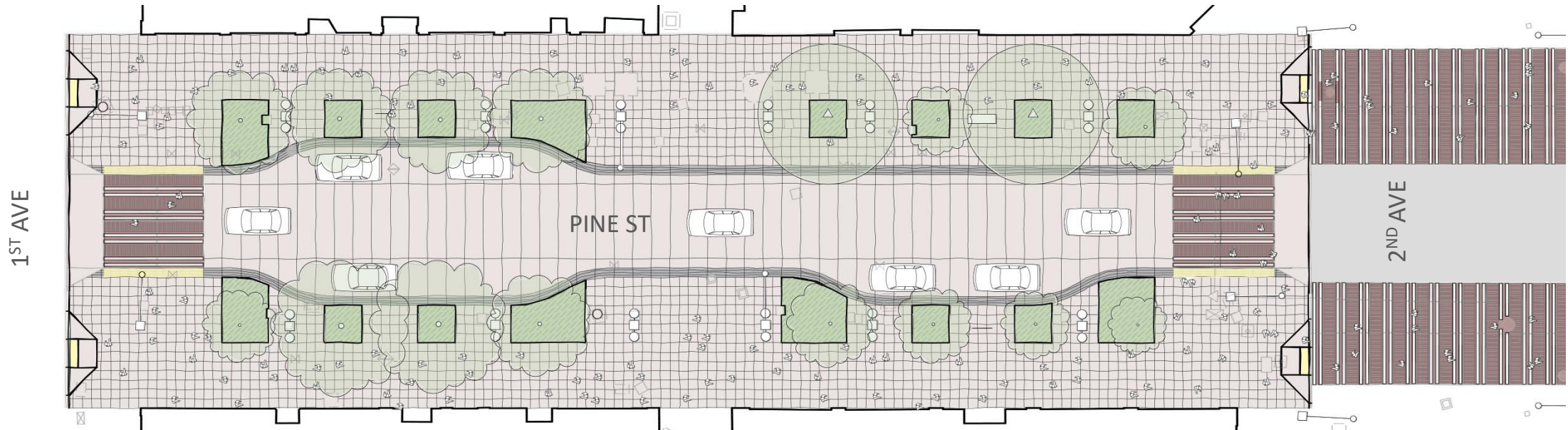

300 PINE EXISTING



300 PINE PROPOSED



300 PINE PROPOSED

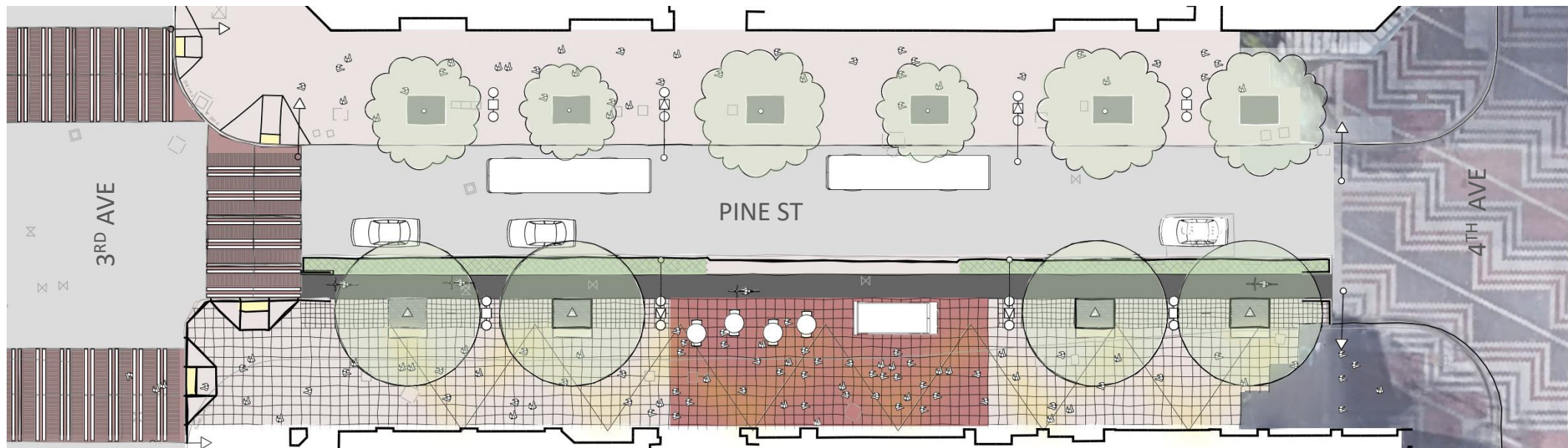

PIKE BRIDGE (2017)



PIKE BRIDGE PROPOSED



PIKE BRIDGE PROPOSED

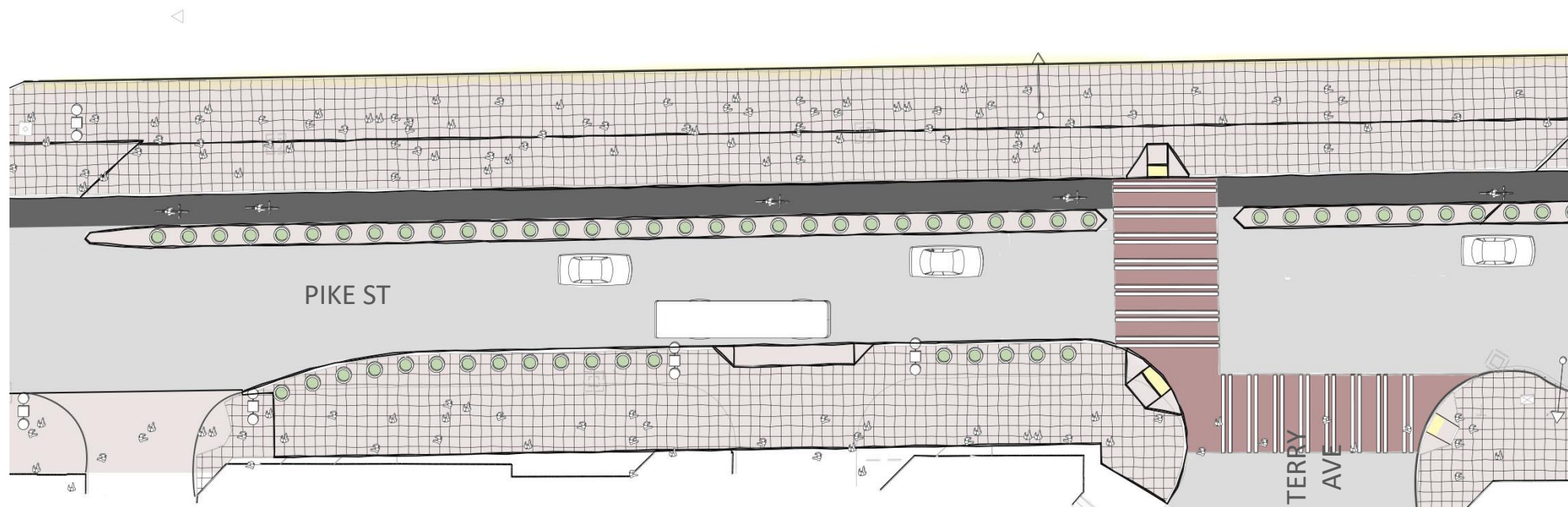

PINE BRIDGE EXISTING



PINE BRIDGE PROPOSED



PINE BRIDGE PROPOSED

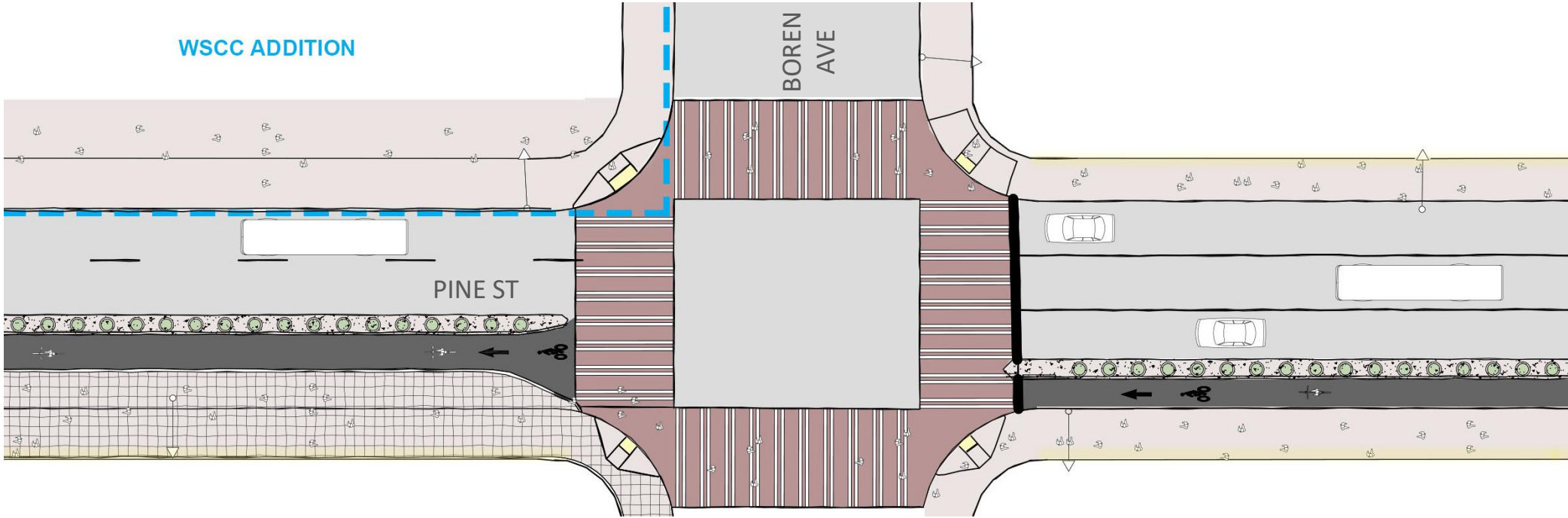

BICYCLE FACILITIES ON PIKE AND PINE STREETS (FOR CLARITY ONLY PIKE & PINE FACILITIES SHOWN)

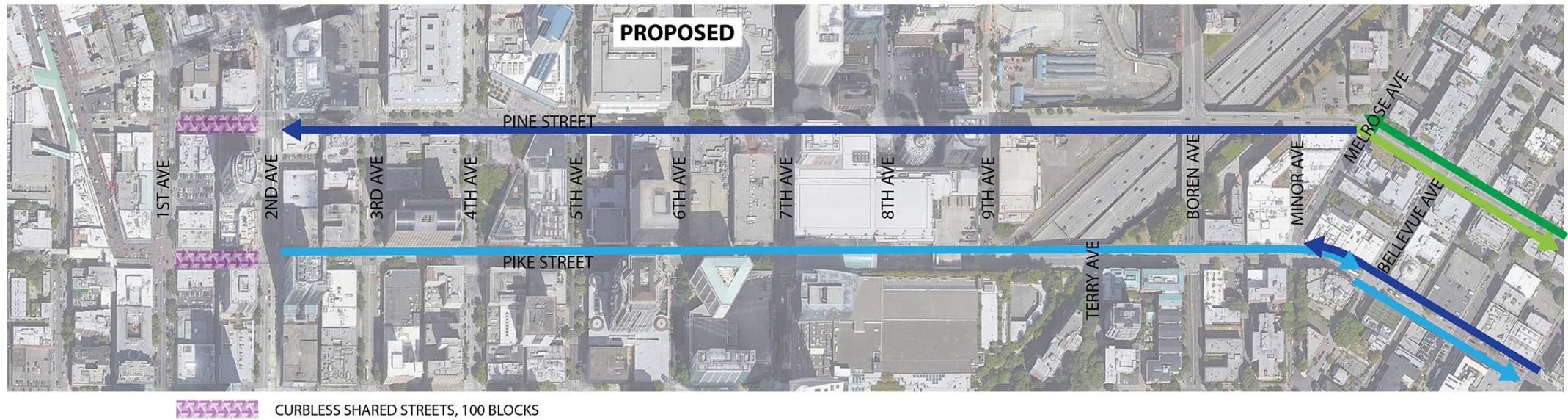
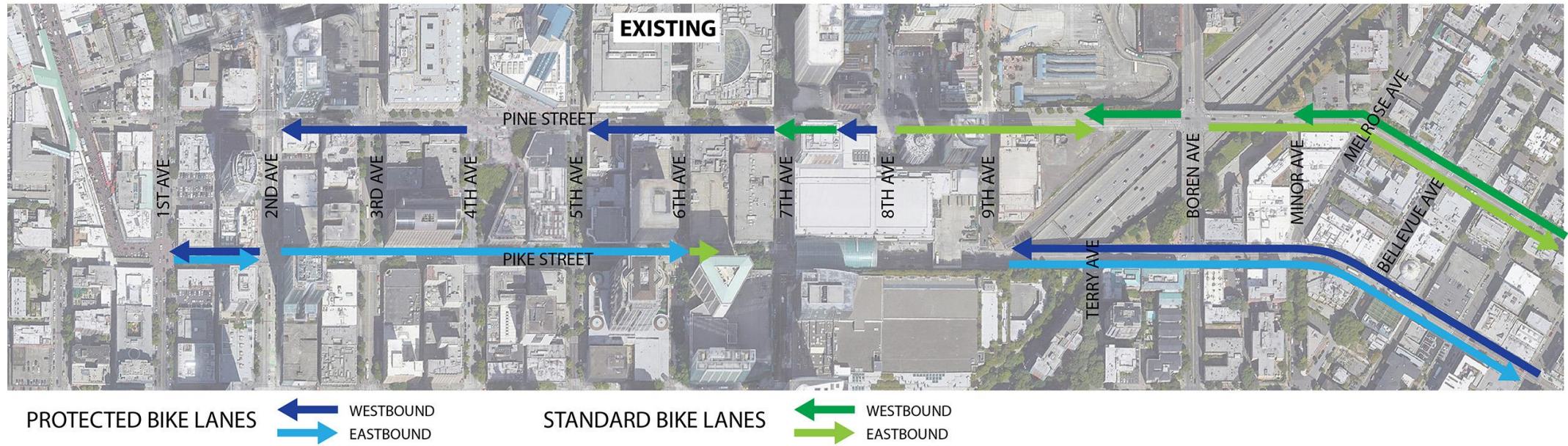

BICYCLE FACILITIES ON PIKE AND PINE STREETS (FOR CLARITY ONLY PIKE & PINE FACILITIES SHOWN)

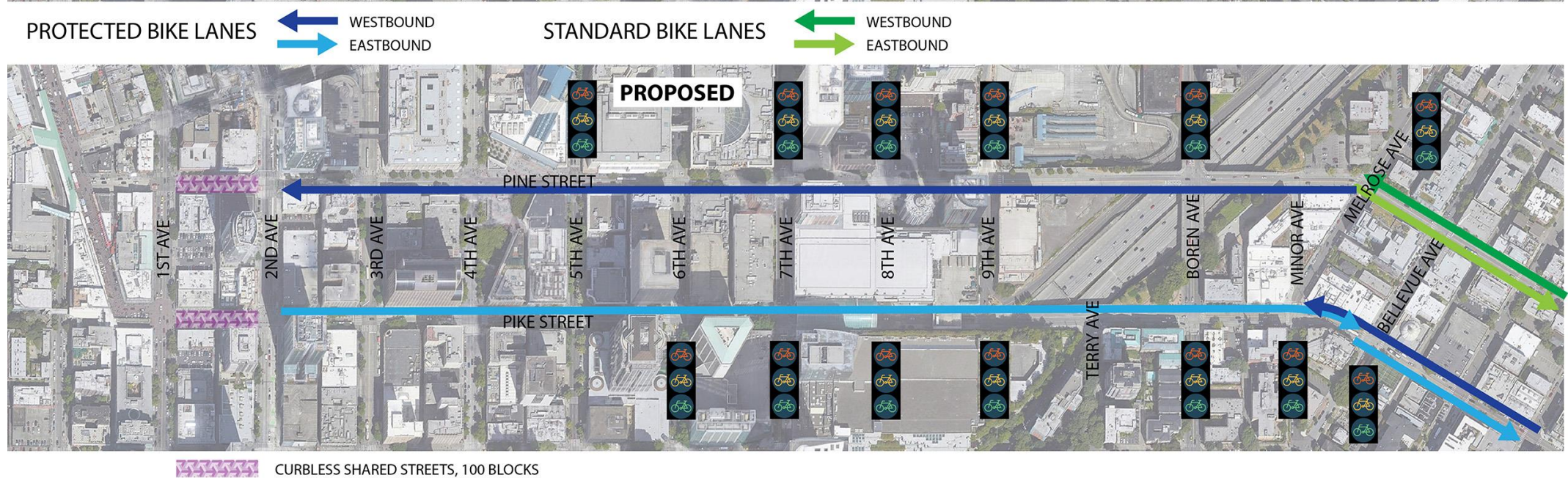
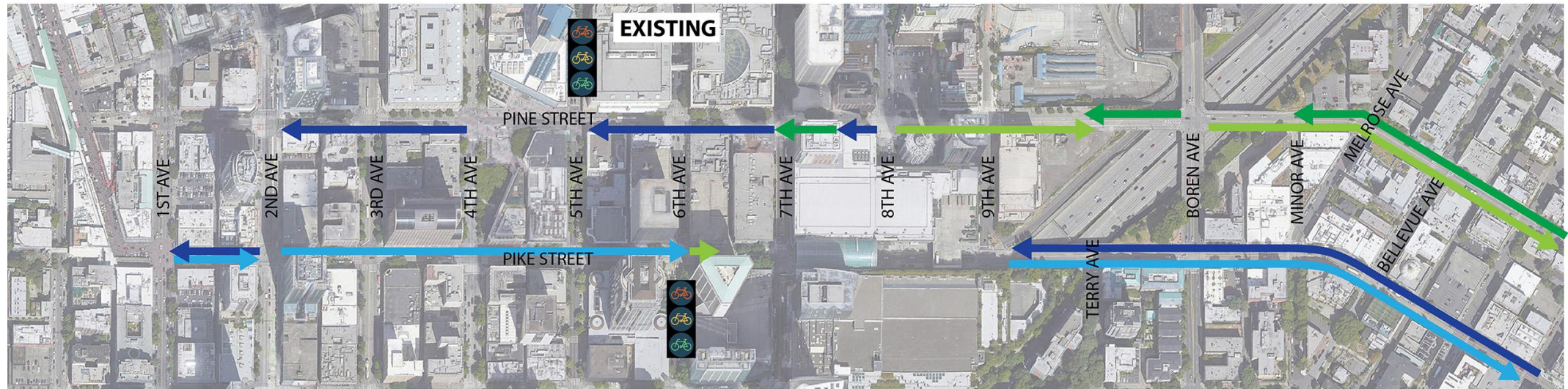

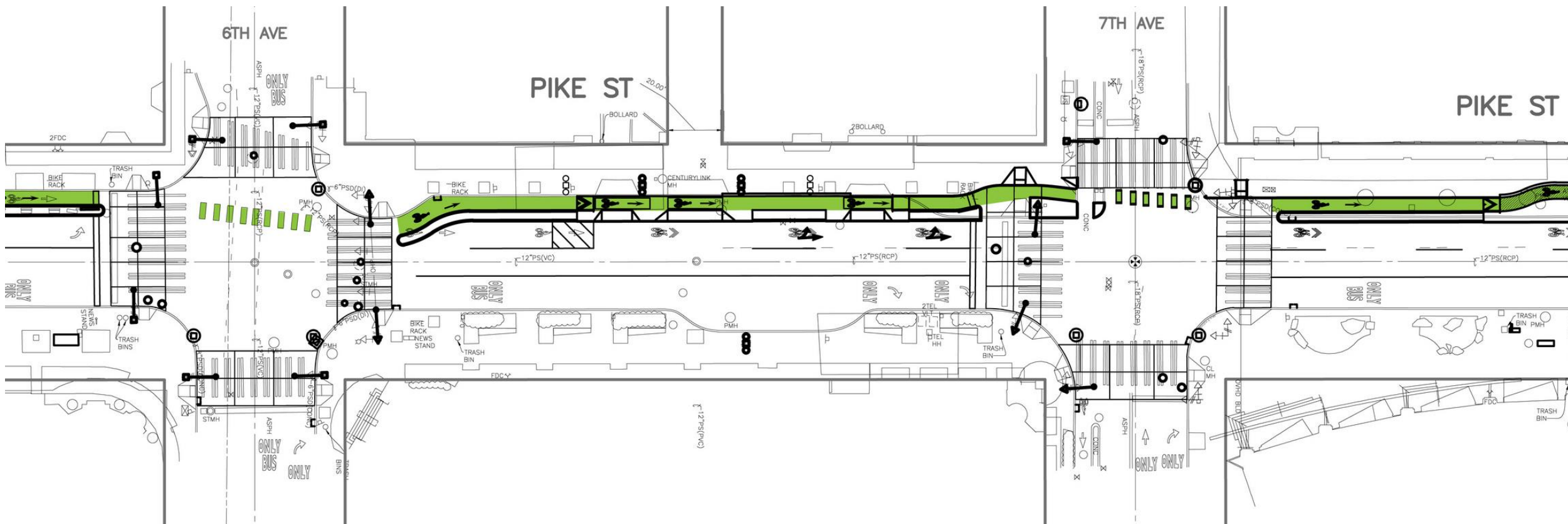

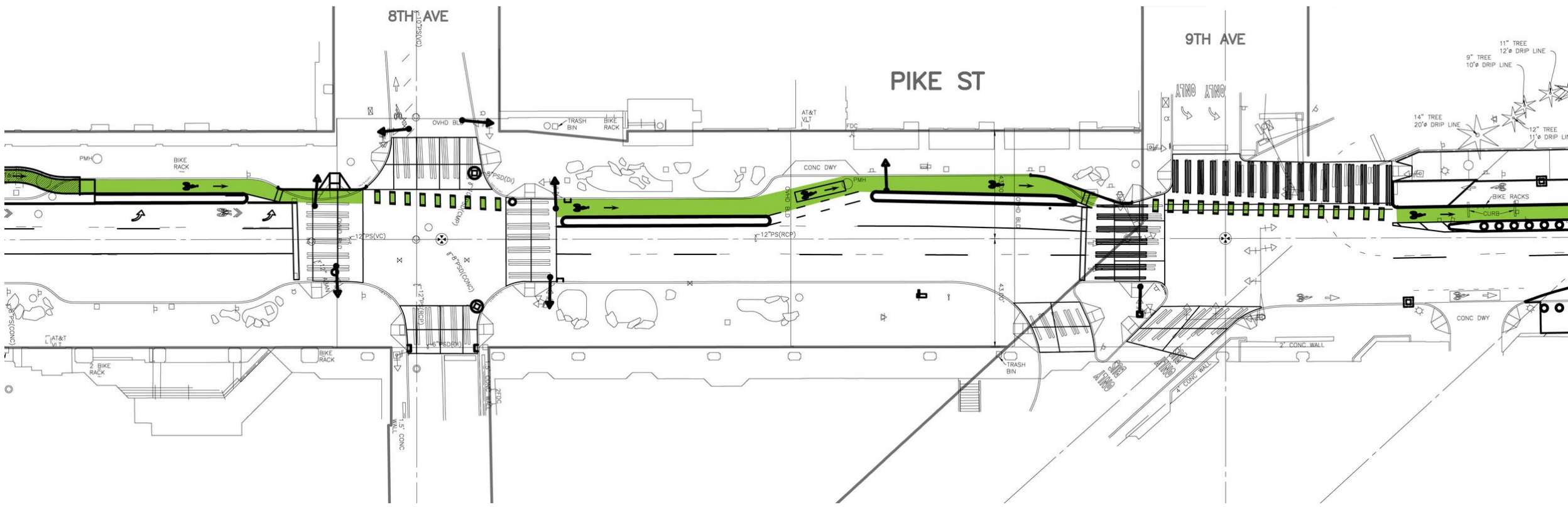

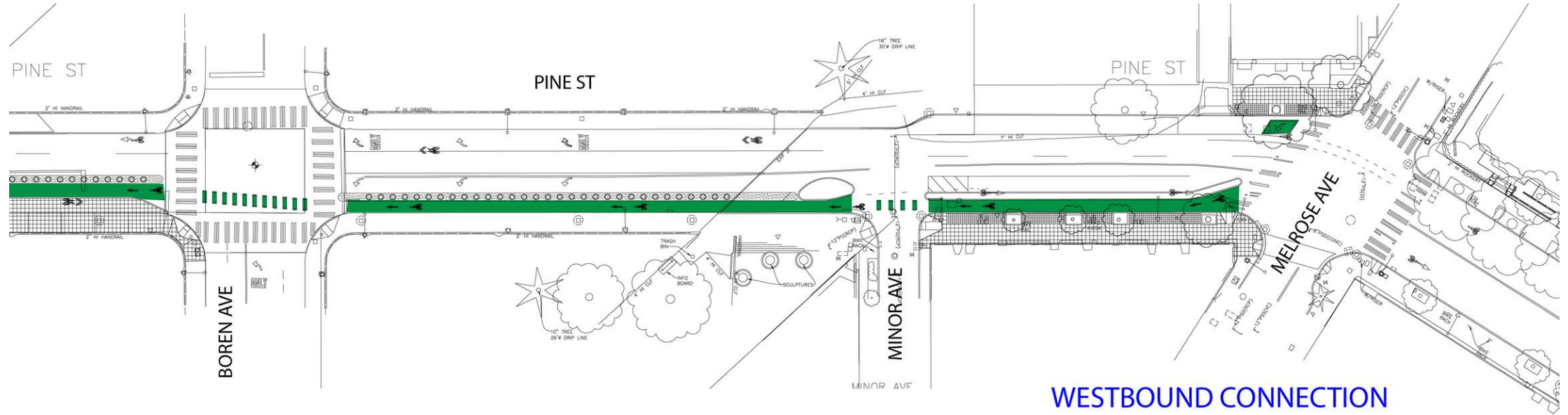

WESTBOUND CONNECTION
USES FUTURE MELROSE
PROMENADE
IMPROVEMENTS BETWEEN
PIKE AND PINE

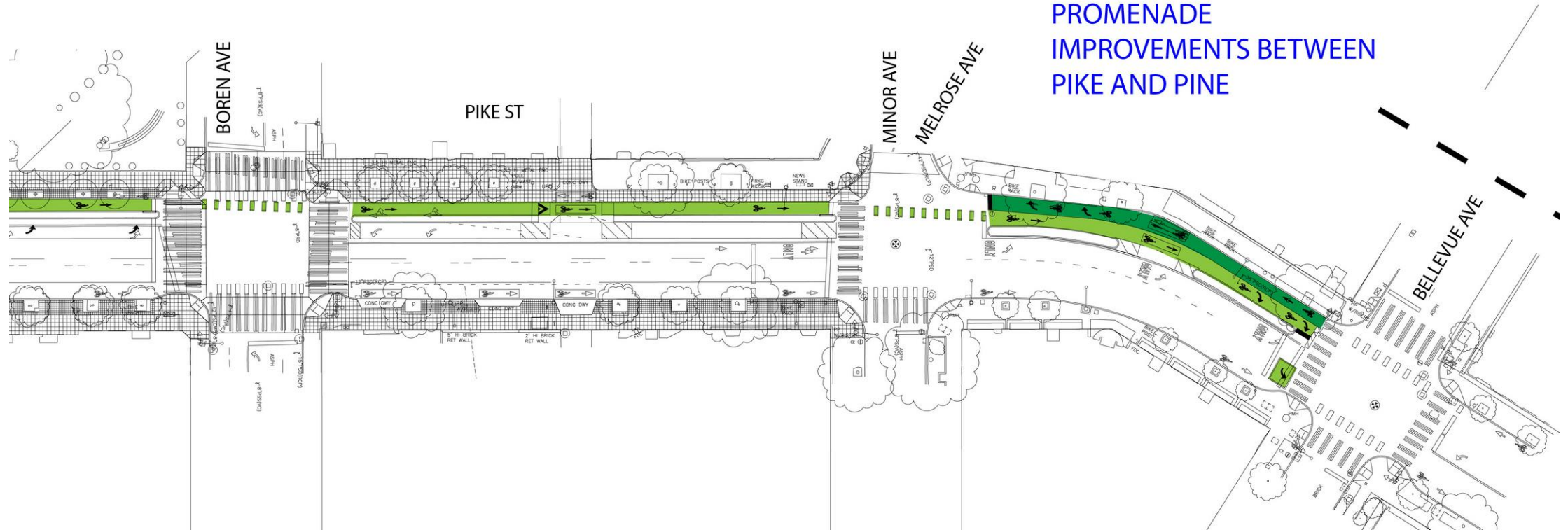

QUESTIONS?